



ASTROLINE

1000T

2,200 LB CAPACITY PROFESSIONAL LOW PROFILE TRANSMISSION JACK

OPERATING INSTRUCTIONS

PARTS LIST

WARRANTY

WARNING:

For Your Safety & To Prevent Injury

1. The vehicle should be properly supported before starting repairs.
2. The use of this jack with recommended adaptors is limited to the removal, installation and transportation in the lowered position.
3. DO NOT lift or support vehicle with this jack.
4. Always use chain to secure load on saddle.
5. Use jack only on hard level surfaces capable of sustaining the load.
6. Make sure weight is evenly distributed.
7. Read and understand the instructional manual.
8. Failure to heed these warnings may result in personal injury and /or property damage.

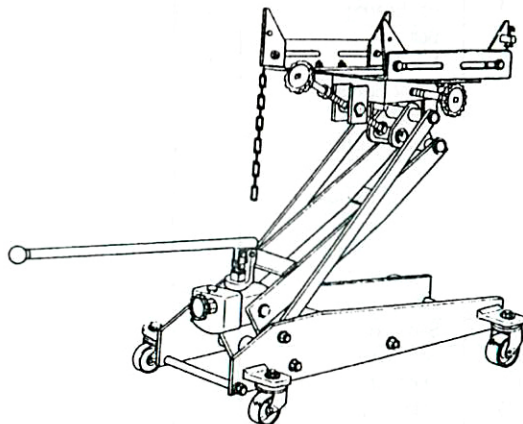

ASSEMBLY INSTRUCTIONS

Place the ANGLE PLATE ASSEMBLY on the SADDLE KIT (088), then attach them with the SPRING WASHER (047) NUT (048) WASHER (091) and BOLT (090).

SPECIFICATIONS

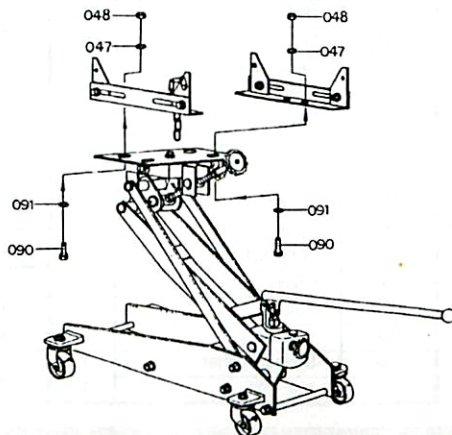
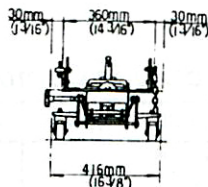
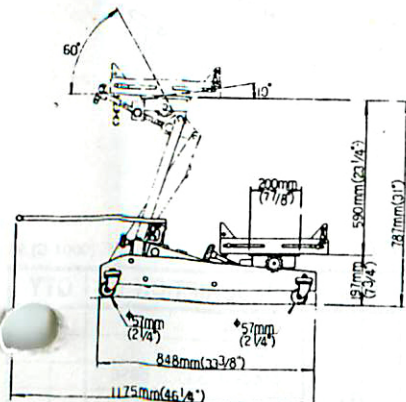

PART	DESCRIPTION	QTY
043	Frame	2
044	Side Link	2
045	Screw, Side Link	2
046	Snap-Ring "E"	2
047	Spring Washer	14
048	Nut	10
049	Caster Bracket	4
050	Rear Caster	4
051	Fork Caster	4
052	Shaft, Rear Caster	4
053	Ball Bearing	4
055	Bolt	4
057	Nut	4
059	Frame Spindle	2
060	Spindle	2
061	Spring Washer	4
062	Nut	5
063	Spindle Tub Ass'y	1
069	Set Screw	1
070	Spindle Base	1
071	Snap-Ring "C"	2
072	Lifting Arm Ass'y	1
073	Saddle Base Ass'y	1
074	Snap-Ring "C"	4
075	Stationary Rod	1
076	Stationary Rod	1
077	Snap-Ring "C"	4
078	Adjustable Screw Ass'y	1
082	Nut	3
083	Screw Set	4
084	Adjustable Screw Ass'y	1
086	Stationary Screw	1
087	Stationary Ring	1
088	Saddle Kit	1
089	Angle Plate	2
090	Bolt	4
091	Washer	4
092	Stationary Plate	4
093	Bolt	4
094	Washer	4
095	Spring Washer	5
096	Nut	5
097	Hook Pin	1
098	Hook Screw	1
099	Wing Nut	1
100	Chain	1
101	Bolt	1
102	Washer	2
103	Spring Washer	1
104	Nut	1

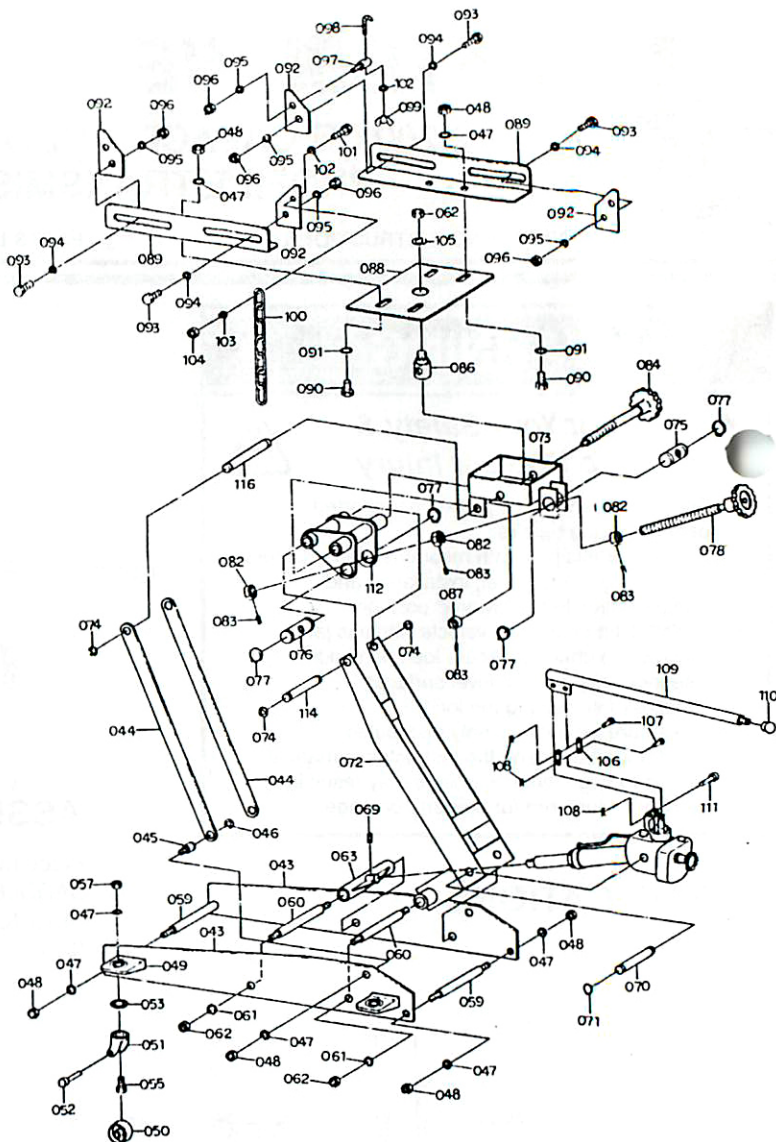

Non-Hydraulic Components

REF. (0001-C) 96

PART	DESCRIPTION	QTY	PART	DESCRIPTION	QTY
105	Washer	1	110	Gripper	1
106	Link	2	111	Pin	1
107	Pin	2	112	Support, Saddle Base	1
108	Cotter Pin	3	114	Connecting Rod	1
109	Handle	1	116	Connecting Rod	1

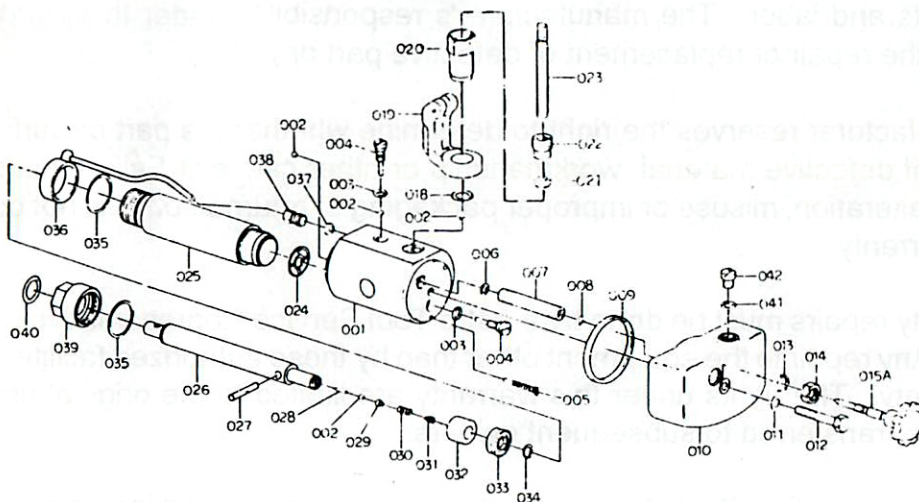

Pump Unit Components

REF. (0001-C) 96

PART	DESCRIPTION	QTY	PART	DESCRIPTION	QTY	PART	DESCRIPTION	QTY
001	Base	1	015A	Release Ass'y	1	031	Screw	1
002	Steel Ball 1/4"	4	018	Washer	1	032	Ram Bushing	1
003	"O" Ring	2	019	Handle Fork	1	033	Cup Set	1
004	Bolt, Check Valve	2	020	Pump Cylinder	1	034	Snap-Ring "C"	1
005	Filter	1	021	Cup Seal	1	035	Packing	2
006	Washer	1	022	Screw	1	036	Air Duct	1
007	Release Valve	1	023	Pump Piston	1	037	Seal	1
008	"O" Ring	1	024	Washer	1	038	Bolt	1
009	Seal	1	025	Cylinder	1	039	Top Nut	1
010	Reservoir	1	026	Ram	1	040	"O" Ring	1
011	Gasket	1	027	Pin	1	041	Seal	1
012	Bolt	1	028	Stem	1	042	Air Vent Valve	1
013	Seal	1	029	Spring Plunger	1			
014	Nut	1	030	Spring	1			

ASTRO 90 DAY LIMITED WARRANTY

The manufacturer warrants this equipment to the original user against defective material or workmanship for a period of 90 days from the date of purchase on repair parts and labor. The manufacturer's responsibility under this warranty is limited to the repair or replacement of defective part or parts.

The manufacturer reserves the right to determine whether the part or parts failed because of defective material, workmanship or other causes. Failure caused by accident, alteration, misuse or improper packaging of returned units is not covered by this warranty.

All warranty repairs must be done by a Astro Tool Service Representative or Astro Factory. Any repair to the equipment other than by these authorized facilities voids this warranty. The rights under this warranty are limited to the original user and may not be transferred to subsequent owners.

The warranty is in lieu of all other warranties, express or implied including warranties of merchantability and fitness for a particular purpose.

WARNING

Do not, under any circumstances, attempt to repair or make any adjustments on your tool, as this will VOID your warranty. These attempts on the part of the user are ALWAYS evident to the service center.



Astro Pneumatic Tool Company
City of Industry, CA
(800) 221-9705

Astro Pneumatic Tool Company • All Rights Reserved • 6/95

MADE IN TAIWAN