



**Astro Pneumatic  
Tool Company**

**HYDRAULIC HAND PALLET TRUCK**

**OPERATING INSTRUCTIONS**

**SPARE PARTS LIST**

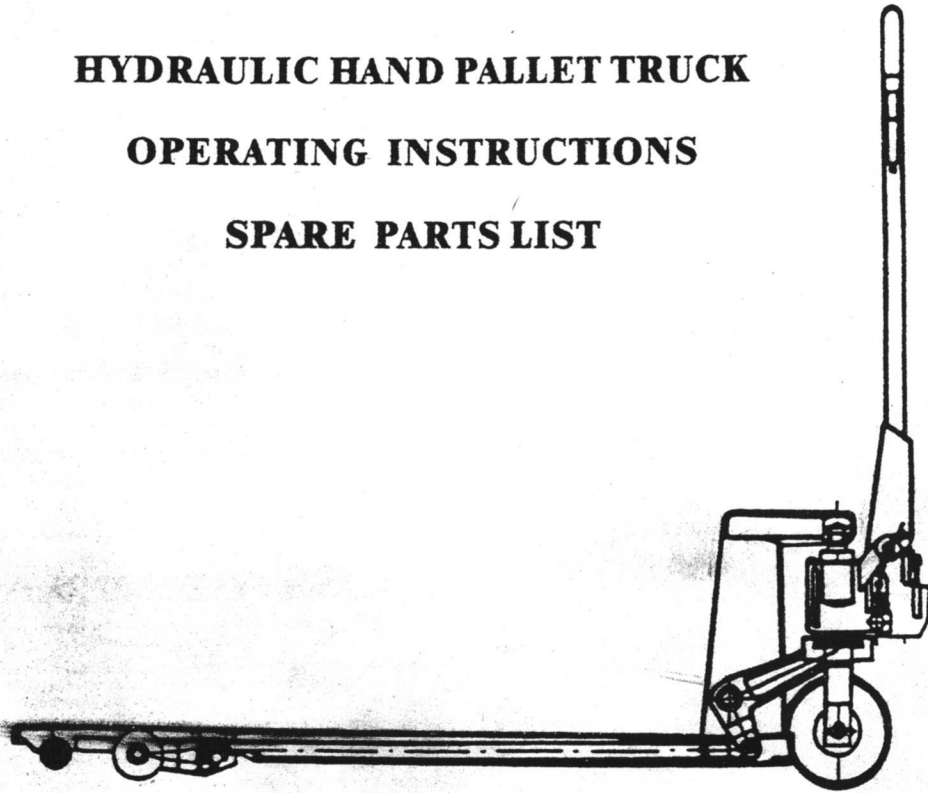

**MODEL NO. 5901**

**Note: Owner and Operator MUST read and understand this operating instructions  
before use this pallet truck.**



Model:

**5901**

Product Type:

**Hydraulic Pallet Truck  
-5,000 lbs. Capacity**

**5901**

### Foreseen Use of the Tool

Do not use the tool outside of the design intent.  
Never modify the tool.



### Safety Precaution

#### Caution: To help prevent personal injury

- Normal use of this product is likely to expose the user to dust and/or microscopic particles containing chemicals known to the State of California to cause cancer, birth defects or other reproductive harm. Always wear appropriate safety equipment and clothing when using this product. Study, understand and follow all instructions provided with this product.
- Always wear ANSI approved goggles when using this product.
- Hand/Wrist/Arm injury may result from repetitive work motion exposure to vibration.

### 1 YEAR LIMITED WARRANTY

The manufacturer warrants this product to the original user against defective material or workmanship for a period of 1 year from the date of purchase.

The manufacturer reserves the right to determine whether the part or parts failed because of defective material, workmanship or other causes. Failures caused by accident, alteration, or misuse are not covered by this warranty.

The manufacturer, at its discretion, will repair or replace products covered under this warranty free of charge. Repairs or replacements of products covered under this warranty are warranted for the remainder of the original warranty period.

The manufacturer or its authorized service representatives must perform all warranty repairs. Any repair to the product by unauthorized service representatives voids this warranty. The rights under this warranty are limited to the original user and may not be transferred to subsequent owners.

This warranty is in lieu of all other warranties, expressed or implied, including warranties of merchantability and fitness for a particular purpose. Some states do not allow the exclusion or limitations of incidental or consequential damages, so the above limitations may not apply to you.

### Product Information:

- 180° pivoting handle
- Touch-control neutral lever
- Steel lifting arms
- Special design oil pressure pump prevents overloading
- Polyurethane rubber coated steel wheels with ball bearings
- Handle returns to upright position when released



**Astro Pneumatic  
Tool Company**

### Important

Read these instructions carefully before installing, operating, servicing or repairing this tool. Keep these instructions in a safe accessible place.

### Unpacking

When unpacking, check the parts diagram and part number listing on pages 3-4 to make sure all parts are included. If any parts are missing or damaged, please call your distributor.

### Hydraulic Pallet Truck - 5,000 lbs. Capacity





**Astro Pneumatic  
Tool Company**

**Hydraulic Pallet Truck  
-5,000 lbs. Capacity**

**5901**

## **MAINTENANCE INSTRUCTION:**

### **1.) LUBRICATION:**

Before connection the hose, apply 4 to 5 drops of #60 spindle oil at the air inlet. After 3 to 4 hours of operation, oiling may be necessary again.

### **2.) TIGHTNESS OF PARTS:**

Regularly check whether all connection parts are **fastened securely**.  
**Follow this procedure daily before beginning work.**

### **3.) CLEANING:**

Dust may accumulate around spindle inside shield.  
It is recommended to remove the dust on a daily basis.

### **4.) STORAGE:**

Avoid storing the tool in a location subject to high humidity.  
If the tool is left unused, the residual moisture inside the tool can cause rust. Before storing and after operation, oil the tool at the air inlet with spindle oil and run it for a short period.

### **5.) DISPOSAL:**

Follow national legislation of waste disposal.  
Never drop into fire.

### **6.) ORDERING SERVICE PART:**

For further operational and handling information or for replacement of parts and components, contact the sales agent from where you purchased the tool, or the service division of our company. \*When ordering parts and components, give each part number, name and quantities.

### **7.) BLEEDING AIR**

To bleed air from hydraulic line: place the handle on the descent position. Then squeeze handle up and down several times. This action bleeds air which should bring pallet truck back to proper performance level.



Users of this tool should review the chemical composition of the work surface and any products used in conjunction with this tool for any such chemicals prior to engaging in any activity that creates dust and/or microscopic particles.

Users should obtain the Material Safety Data Sheets for all identified chemicals, either from the manufacturer or their employer, and proceed to study, understand, and follow all instructions and warnings for exposure to such chemicals.

Some examples of these chemicals are: lead from lead based paints; crystalline silica from bricks, cement and other masonry products; and arsenic and chromium from chemically treated lumber. A listing of the chemicals can be obtained at [www.cdc.gov](http://www.cdc.gov) under Proposition 65.

In order to reduce their exposure to such chemicals users should always:

- work in well-ventilated areas
- wear appropriate safety equipment and clothes that are specifically designed to filter out microscopic particles

## **GUIDELINES FOR SAFE OPERATION:**

Read all warnings and instructions before attempting to use.

Do not operate unless you are trained and authorized to do so.

Do not operate pallet truck unless you have inspected its condition giving special attention to the wheels, the handle unit, fork unit, and release valve lever.

Do not use on sloping ground

Do not carry passengers.

Lift no one under any circumstances.

Wear gloves during operation of pallet jack.

Do not handle loose or unstable loads.

Do not exceed rated capacity.

Never place any body part between fork and surface/floor or between pallet and fork. Avoid trapping.

Keep clear view of travel path. If view of path is obstructed, adjust load and proceed on path of travel once view is no longer obstructed.

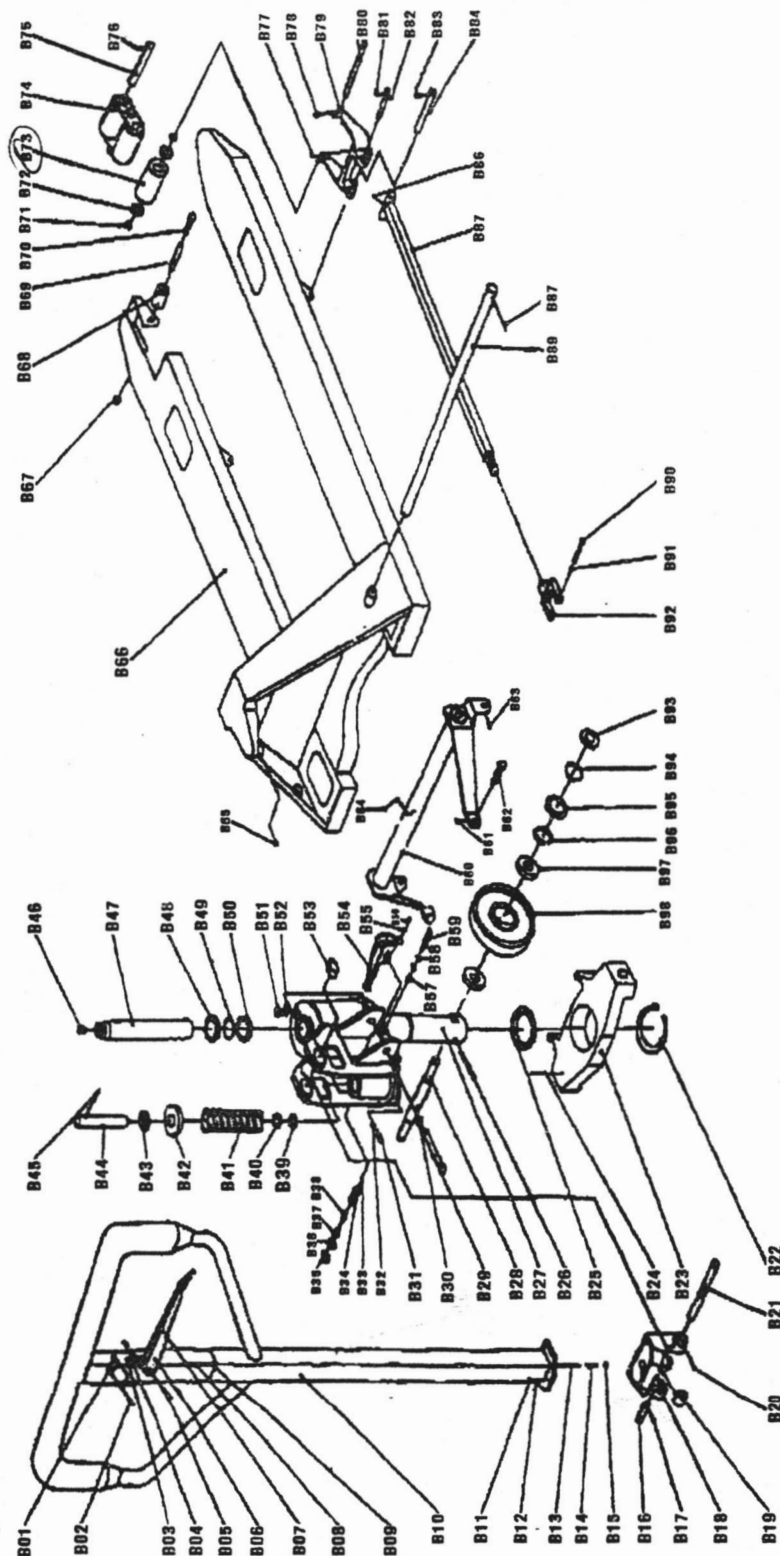



**Astro Pneumatic  
Tool Company**

**Hydraulic Pallet Truck  
-5,000 lbs. Capacity**

**5901**

| NO. | DESCRIPTION              | QTY. | NO. | DESCRIPTION            | QTY.  | NO. | DESCRIPTION             | QTY |
|-----|--------------------------|------|-----|------------------------|-------|-----|-------------------------|-----|
| B1  | SPRING                   | 1    | B43 | PROTECTING COVER       | 1     | B86 | OILER                   | 2   |
| B2  | ELASTIC PIN              | 2    | B44 | SMALL PISTON ROD       | 1     | B87 | STRAIGHT TAPPET         | 2   |
| B3  | ROLLER                   | 1    | B45 | ELASTIC PIN            | 1     | B88 | ELASTIC PIN             | 1   |
| B4  | ELASTIC PIN              | 1    | B46 | STEEL BALL             | 1     | B89 | LONG SHAFT              | 1   |
| B5  | ELASTIC PIN              | 1    | B47 | BIG PISTON ROD         | 1     | B90 | PIN                     | 2   |
| B6  | ELASTIC PIN              | 1    | B48 | DUST RING              | 1     | B91 | RETAINING RING FOR AXLE | 2   |
| B7  | HANDLE                   | 1    | B49 | O-RING                 | 1     | B92 | JOINT                   | 2   |
| B8  | BLADE SPRING             | 1    | B50 | U TYPE SEALING RING    | 1     | B93 | DUST COVER              | 2   |
| B9  | PULL ROD                 | 1    | B51 | INSIDE HEX PLUG        | 2     | B94 | RETAINING RING FOR AXLE | 2   |
| B10 | HAND TUBE                | 1    | B52 | COPPER WASHER          | 2     | B95 | BOWL NUT                | 2   |
| B11 | NUT                      | 3    | B53 | BUSHING                | 2     | B96 | HALF CIRQUE             | 2   |
| B12 | WASHER                   | 3    | B54 | LEVER PLATE            | 1     | B97 | BEARING                 | 4   |
| B13 | CHAIN                    | 1    | B55 | NUT                    | 1     | B98 | STEER WHEEL             | 2   |
| B14 | ADJUSTING SCREW          | 1    | B56 | REGULATE SCREW         | 1     |     |                         |     |
| B15 | NUT                      | 1    | B57 | SPRING                 | 1     |     |                         |     |
| B16 | PRESSURE ROLLER SHAFT    | 1    | B58 | O-RING                 | 2     |     |                         |     |
| B17 | ELASTIC PIN              | 1    | B59 | VALVE TAPPET           | 1     |     |                         |     |
| B18 | PRESSURE FRAME           | 1    | B60 | ROCKER ARM             | 1     |     |                         |     |
| B19 | PRESSURE ROLLER          | 1    | B61 | OILER                  | 2     |     |                         |     |
| B20 | ELASTIC PIN              | 1    | B62 | HEX SHORT SHAFT        | 2     |     |                         |     |
| B21 | PRESSURE SHAFT           | 1    | B63 | OILER                  | 2     |     |                         |     |
| B22 | RETAINING RING FOR AXLE  | 1    | B64 | OILER                  | 1     |     |                         |     |
| B23 | SUPPORTING BASE          | 1    | B65 | INSIDE HEX SCREW       | 1     |     |                         |     |
| B24 | ELASTIC PIN              | 1    | B66 | FORK FRAME             | 1     |     |                         |     |
| B25 | BEARING                  | 1    | B67 | NUT                    | 2     |     |                         |     |
| B26 | ELASTIC PIN              | 1    | B68 | PILOT WHEEL            | 2     |     |                         |     |
| B27 | BASE FRAME               | 1    | B69 | SHEATH                 | 2     |     |                         |     |
| B28 | SHAFT                    | 1    | B70 | BOLT                   | 2     |     |                         |     |
| B29 | PIN LEVER                | 1    | B71 | WASHER                 | 4(8") |     |                         |     |
| B30 | RETAINING RING FOR AXLE  | 1    | B72 | BEARING                | 4(8") |     |                         |     |
| B31 | INSIDE HEX SCREW         | 1    | B73 | FORK WHEEL             | 2(4") |     |                         |     |
| B32 | STEEL BRAD               | 1    | B74 | NOG OF FORK WHEEL      | 4"    |     |                         |     |
| B33 | STEEL BRAD               | 1    | B75 | SHAFT FOR DOUBLE WHEEL | 4"    |     |                         |     |
| B34 | SEAT OF DAMPING VALVE    | 1    | B76 | ELASTIC PIN            | 8"    |     |                         |     |
| B35 | PLUG                     | 1    | B77 | OILER                  | 4     |     |                         |     |
| B36 | COPPER WASHER            | 1    | B78 | ELASTIC PIN            | 2(0") |     |                         |     |
| B37 | SPRING                   | 1    | B79 | FRAME OF FORK WHEEL    | 2     |     |                         |     |
| B38 | SPINDLE OF DAMPING VALVE | 1    | B80 | SHAFT OF FORK WHEEL    | 2     |     |                         |     |
| B39 | U TYPE SEALING RING      | 1    | B81 | ELASTIC PIN            | 2     |     |                         |     |
| B40 | DUST RING                | 1    | B82 | SHORT SHAFT            | 2     |     |                         |     |
| B41 | SPRING                   | 1    | B83 | ELASTIC PIN            | 2     |     |                         |     |
| B42 | HOOD                     | 1    | B84 | SHAFT                  | 2     |     |                         |     |

\* THESE QUANTITIES ARE USED FOR THE DOUBLE FORK WHEEL.



## **TROUBLESHOOTING:**

| <b>TROUBLE</b>                                   | <b>CAUSE</b>   | <b>FIXING METHODS</b>  |
|--|--|--|
| Forks cannot attain maximum height               | Hydraulic oil volume is below minimum requirement  | - Add oil to increase oil volume   |
| Forks will not raise                             | <ul style="list-style-type: none"><li>- No hydraulic oil</li><li>- The oil has impurities.</li><li>- Air is in the hydraulic line and should be bled.</li></ul>  | <ul style="list-style-type: none"><li>- fill in the oil.</li><li>- Change the oil.</li><li>- Adjust the nut or the screw on the release fork.</li></ul>  |
| Forks will not lower                             | <ul style="list-style-type: none"><li>- Piston rod or pump body is deformed as a result from the piston rod or extreme side loading.</li><li>- The fork was kept in the high position for an extended length of time with piston rod exposed causing oxidation which results in jamming of rod.</li><li>- The adjusting nut and/or screw is positioned incorrectly on the release valve.</li></ul> | <ul style="list-style-type: none"><li>- Replace the piston rod or pump body.</li><li>- Keeping the fork in the lowest position if not using and pay more attention to lubricate the rod.</li><li>- Adjust the nut screw to proper position.</li></ul>              |
| Leaks  | <ul style="list-style-type: none"><li>- Sealing parts worn or damaged.</li><li>- Some parts are cracked or worn out.</li></ul>   | <ul style="list-style-type: none"><li>- Replace with new sealing parts.</li><li>- Replace cracked or worn parts.</li></ul>   |
| Forks lower without release lever being actuated | <ul style="list-style-type: none"><li>- The impurities in the oil cause the release valve to be unable to close tight.</li><li>- Some parts of hydraulic system is cracked or bored.</li><li>- Air in hydraulic line.</li><li>- Sealing parts worn or damaged.</li><li>- The adjusting nut and/or screw is positioned incorrectly.</li></ul>   | <ul style="list-style-type: none"><li>- Replace with new oil.</li><li>- Inspect and replace parts as needed.</li><li>- Bleed air from hydraulic line.</li><li>- Replace as needed.</li><li>- Adjust the nut and/or screw to preferred performance level.</li></ul> |