

OWNER'S MANUAL

CONTENTS:

Page	1	Press Specifications
	2	Warning Information
	3	Safety Instructions and Inspection
	4-5	Operating Instructions
	6-7	Winch Cable Routing and Adjustment
	8	Replacement Parts List
	9	Pump and Ram Exploded Parts Diagram
	10	Limited Warranty

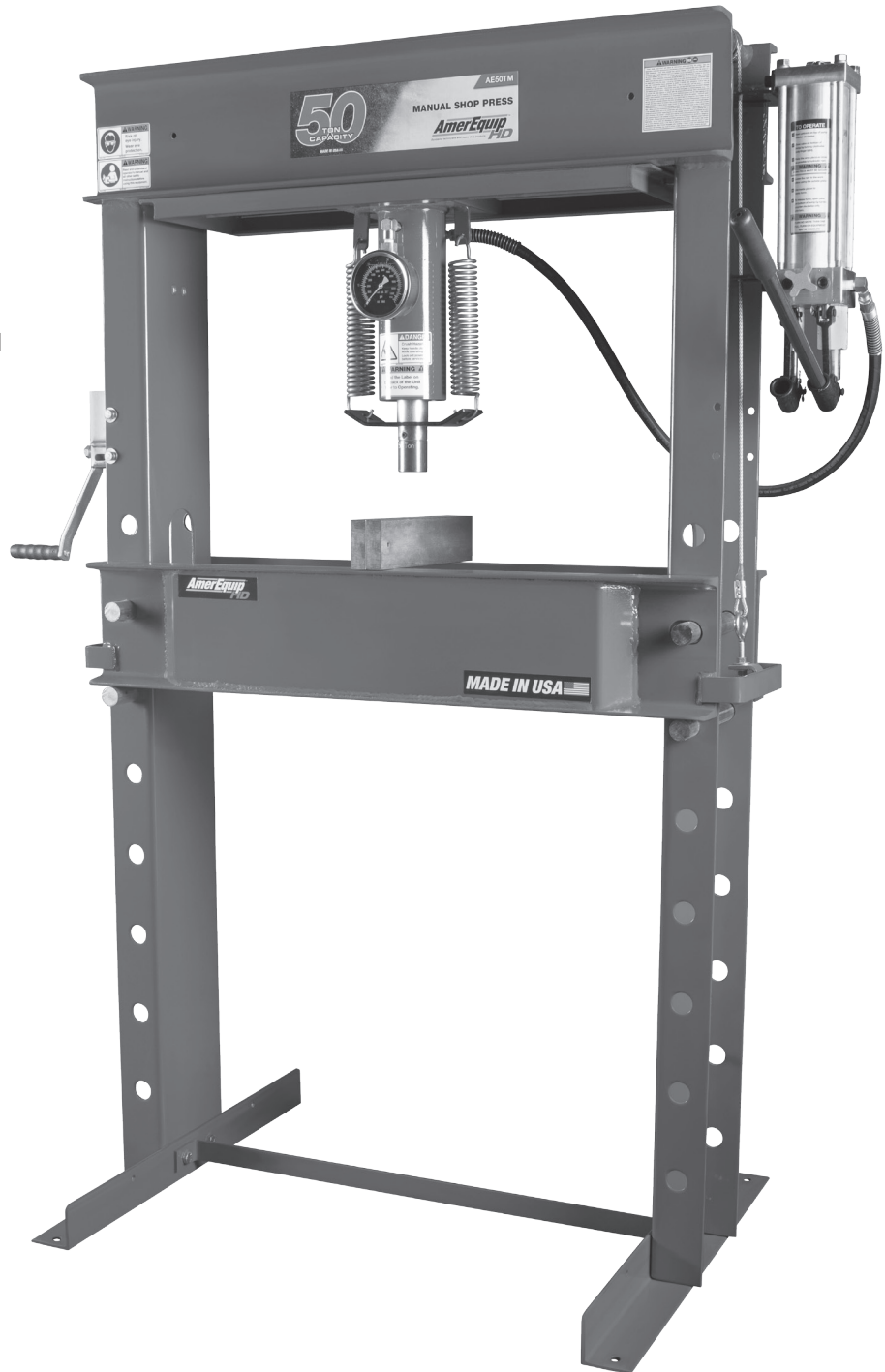

PRESS SPECIFICATIONS

Ram Travel	Throat Height Min.	Throat Height Max.	Throat Width	Bed Adjustments	Bed Width (Between Rails)	Base Depth	Base Width	Overall Height
6"	5-1/2"	30-1/2"	34"	7 @ 5" apart	8-1/4"	29-3/4"	35"	74"

WARNING INFORMATION



This is the safety alert symbol. It is used to alert you to potential personal injury hazards. Obey all safety messages that follow this symbol to avoid possible injury or death.

WARNING

WARNING: Indicates a hazardous situation which, if not avoided, could result in death or serious injury.



IMPORTANT: READ THESE INSTRUCTIONS BEFORE OPERATING

BEFORE USING THIS DEVICE, READ THIS MANUAL COMPLETELY AND THOROUGHLY. UNDERSTAND ITS OPERATING PROCEDURES, SAFETY WARNINGS AND MAINTENANCE REQUIREMENTS.

It is the responsibility of the owner to make sure all personnel read this manual prior to using the device. It is also the responsibility of the device owner to keep this manual intact and in a convenient location for all to see and read. If the manual or product labels are lost or not legible, contact AmerEquip™ for replacements. If the operator is not fluent in English, the product and safety instructions shall be read to and discussed with the operator in the operator's native language by the purchaser/owner or his designee, making sure that the operator comprehends its contents.

THE NATURE OF HAZARDOUS SITUATIONS

WARNING

The use of shop presses and their accessories is subject to certain hazards that cannot be prevented by mechanical means, but only by the exercise of intelligence, care, and common sense. It is therefore essential to have owners and personnel involved in the use and operation of the equipment who are careful, competent, trained, and qualified in the safe operation of the equipment and its proper use. Examples of hazards are components being pressed and breaking resulting in flying parts that are not secured from hitting the operator, the set up in the press is not secure, guards, shields or protective blankets are not used, improperly securing adjustments on the press, overloading and off-center loads.

METHODS TO AVOID HAZARDOUS SITUATIONS

WARNING



- Read, study, understand and follow all instructions before operating this press.
- Prior to use make sure the press is securely anchored to a concrete floor, installed and operated in accordance with OSHA, state and local safety standards.



- Visual inspection of the press should be made before use, checking for signs of cracked welds, bent bed pins, loose or missing bolts, leaks, or any other structural damage. Corrections must be made before using the press.
- No alterations shall be made to this press.
- Operators and observers shall wear eye protection that meets ANSI Z87.1 and OSHA Standards.
- Parts being pressed may splinter, shatter, or be ejected from the press at a dangerous rate of speed. Due to a variety of press applications, it is the press owner's responsibility to provide adequate guards, eye protection and protective clothing to the press operator.
- Always use a bearing shield when pressing bearings.
- Keep hands, arms, feet, and legs out of work area. Accidental slippage can result in personal injury.
- Remove all loads from movable bolster before adjusting bolster height. Beware of falling bolster.
- Press only on loads supported by movable bolster and press plates. Do not support loads on floor or press frame legs.
- When using any accessories such as press or arbor plates, be certain they are centered on the movable bolster and in full contact with both sides of the bolster.
- Use caution when positioning work to be pressed to ensure the item to be pressed cannot be ejected at a dangerous rate of speed.
- Avoid off-center loads. Do not use spacers or extenders between the press ram plunger and the item being pressed. If there is not enough ram stroke, adjust the height of the movable bolster.
- Before applying load, be certain all movable bolster supporting pins are fully engaged. Make sure movable bolster lift cables (if equipped) are slack before pressing on bolster.
- Do not exceed the rated capacity. When attachments and adapters are used, the rated capacity of the system shall be no greater than the rated capacity of the lowest-rated component or combination of components that make up the system.
- Always use an accurate force gauge to measure pressing force.
- Do not tamper with the press load-limiting device settings.
- Do not go near leaks. High pressure hydraulic fluid can puncture skin and cause serious injury, gangrene, or death. Do not use finger or skin to check for leaks. If injured, seek emergency medical help as immediate surgery is required to remove the fluid.
- Release hydraulic pressure before loosening any fittings.
- Maintain proper hydraulic fluid levels.
- This product may contain one or more chemicals known to the State of California to cause cancer and birth defects or other reproductive harm. *Wash hands thoroughly after handling.*
- Failure to understand and heed these markings may result in serious or fatal personal injury and/or property damage.

WARNING INFORMATION (CONTINUED)

CONSEQUENCES OF NOT AVOIDING HAZARDOUS SITUATIONS

⚠ WARNING

Failure to read this manual completely and thoroughly, failure to understand its OPERATING INSTRUCTIONS, SAFETY WARNINGS, MAINTENANCE INSTRUCTIONS and comply with them, and failure to comply with the METHODS TO AVOID HAZARDOUS SITUATIONS could cause accidents resulting in serious or fatal personal injury and/or property damage.

SAFETY INSTRUCTIONS AND INSPECTION

SAFETY INSTRUCTIONS

- CHECK YOUR LOCAL, STATE AND FEDERAL REGULATIONS REGARDING THE SAFE USE OF THIS EQUIPMENT.
- Your safety is top priority. Please handle equipment with care.
- Fully retract unit and remove all items from the press bed frame.
- Support the press bed, and remove the pins.
- Raise or lower bed to desired height and reinstall press pins. Be certain pins are fully engaged in the parallel flanges of the upright columns.
- Position press on a flat, level, hard surface, preferably concrete.
Make sure all nuts and bolts are tight.
- Clear the area of bystanders, especially small children, before using.
- Set the press bed to the required height. The press is most effective when the work piece is located 1 inch below the ram's retracted position. The compression stroke can include the entire 5" working range.
- The press is designed to exert a force on anything which is positioned beneath its ram. The work piece can pop out from under the ram at a high rate of speed and injure someone.
- Pressing Bearings: It is essential that you use the bearing shield when pressing bearings on or off.

INSPECTION

Visual inspection of the shop press should be made before each use of the press, checking for damaged, loose or missing parts. Each press must be inspected by an authorized service center immediately if subjected to an abnormal load or shock. Any press which appears to be damaged in any way, is found to be badly worn, or operated abnormally must be prevented from being used until necessary repairs are made by an authorized service center. It is recommended that an annual inspection of the press be made by an authorized service center and that any defective parts, missing or damaged warning labels be replaced with AmerEquipTM parts and labels.

OPERATING INSTRUCTIONS

Air may become trapped in the hydraulic system during shipping and/or handling. Symptoms of an air trapped system are a spongy feeling when pumped, pump does not feel like it is providing a full pump stroke of fluid, or the cylinder ram does not extend smoothly when the pump is operated. Follow the procedure below to remove air from the hydraulic system.

1

⚠ WARNING

DO NOT attempt to operate pump unless the BREATHER VALVE IS OPEN. Valve is closed prior to shipping to prevent the loss of hydraulic fluid.

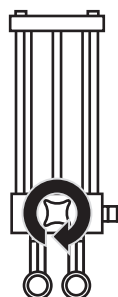
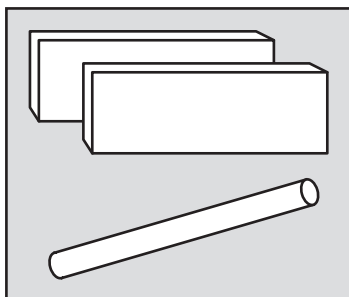

1. Turn valve handle on FRONT of pump CLOCKWISE until closed. DO NOT OVERTIGHTEN.

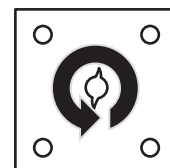

2. Turn petcock valve (breather) on TOP of pump COUNTERCLOCKWISE to open.

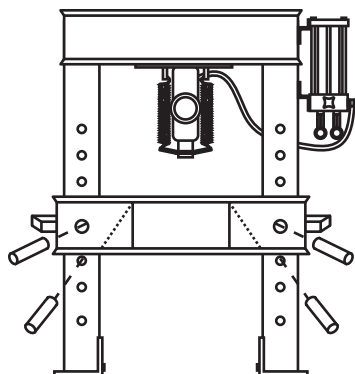

3. Move press bed into highest position and lock bed into place with both pins.

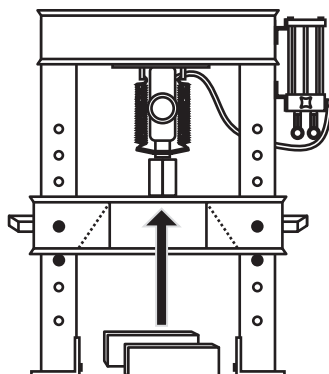

4. Place press plates DIRECTLY under ram, on press bed.

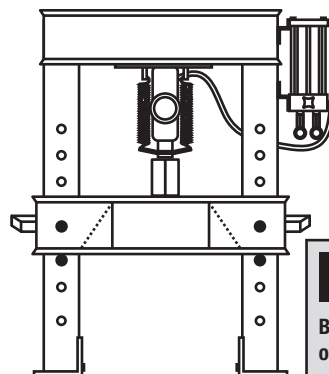

5. Put cradle in the DOWN position. Use an adapter on your air hose and allow air to flow through the opening in the petcock valve into the pump.

⚠ CAUTION

Bed must be in UP position, or you will over extend ram.

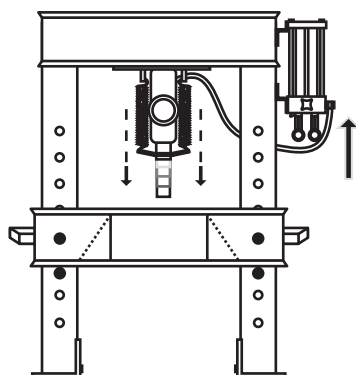

6. Air that has flowed into the pump causes the cradle to move up and the ram to move down. If this happens, proceed to step 7. If not, check all hoses and connections and repeat the procedure.

⚠ WARNING

DO NOT allow the ram to extend more than 5.5".

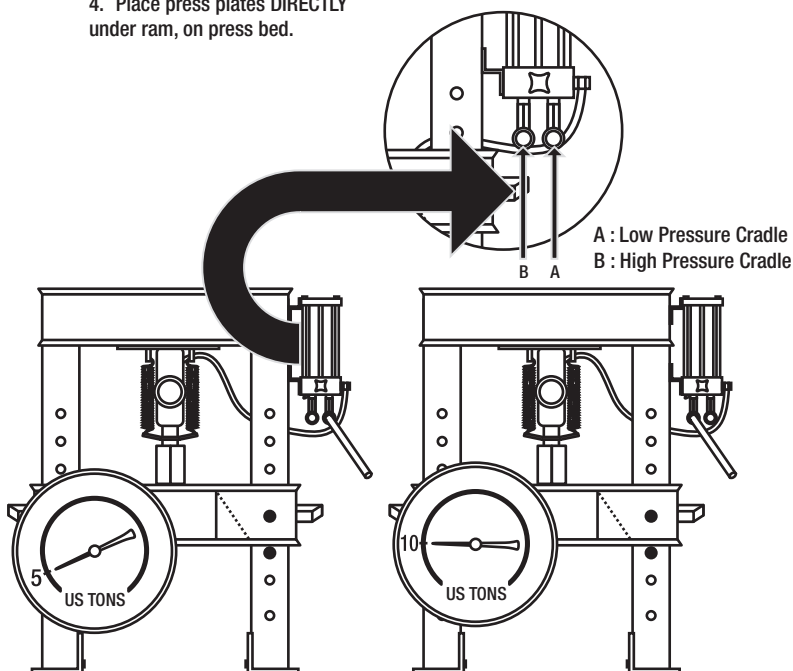

7. Insert pump handle into LOW PRESSURE CRADLE. Pump ram against press plates until gauge reads "5 Tons".

8. Insert pump handle into HIGH PRESSURE CRADLE. Pump ram against press plates until gauge reads "10 Tons".

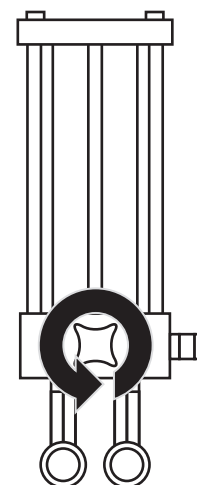

9. Turn valve handle on pump COUNTERCLOCKWISE a maximum of one (1) turn to open valve. Ram will retract as pressure is released.

OPERATING INSTRUCTIONS (CONTINUED)

2

⚠ WARNING

This symbol alerts you to the possibility of serious injury or death if instructions are not followed.

Failure to heed these warnings may result in loss of load, damage to the press and/or failure resulting in property damage, personal or fatal injury. This operating manual contains important details concerning the safe operation of this press. The user must read and understand these details before any use of the press.

This manual must be retained for future reference.

1. BEFORE OPERATING PUMP, open petcock valve (breather) located on TOP of pump assembly by turning COUNTERCLOCKWISE.

Top view of pump

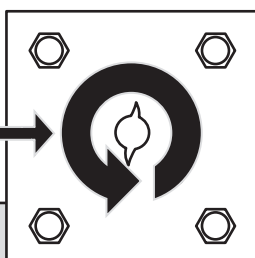

⚠ WARNING

DO NOT attempt to operate pump unless the BREATHER VALVE IS OPEN. Valve is closed prior to shipping to prevent the loss of hydraulic fluid.

2. CLOSE the valve located on the FRONT of the pump assembly by turning CLOCKWISE.

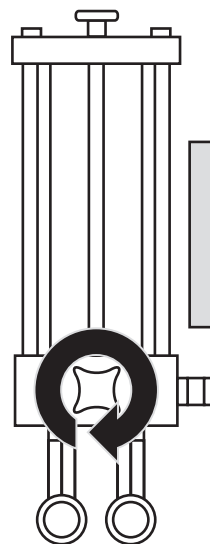

⚠ CAUTION

HAND TIGHTEN VALVE ONLY. Excess pressure could damage the valve assembly.

3. Insert pump handle into low pressure cradle. Use the low pressure pump until ram comes into contact with item to be pressed.

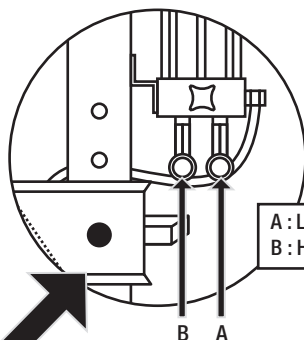

A : Low Pressure Cradle
 B : High Pressure Cradle

4. Once ram is in contact with the item to be pressed, insert pump handle into high pressure side. Using the high pressure pump moves the ram less with each stroke and requires less effort to apply pressure.

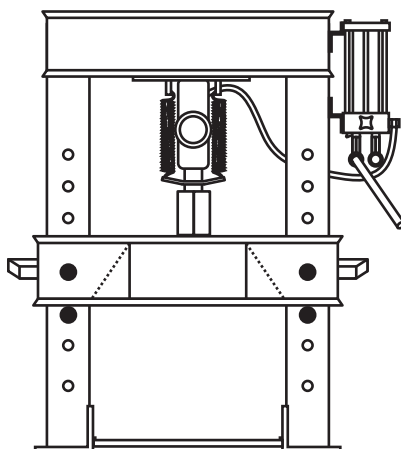
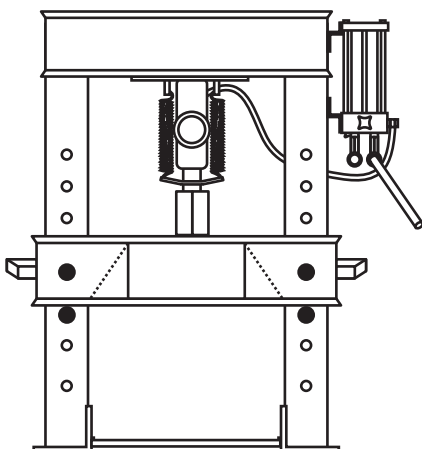

5. To relieve pressure and retract ram, turn valve located on FRONT of pump assembly ONE FULL TURN COUNTERCLOCKWISE.

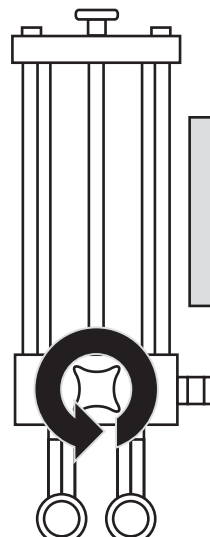

⚠ CAUTION

DO NOT TURN RELEASE VALVE MORE THAN ONE FULL TURN or equipment may be disabled.

WINCH CABLE ROUTING AND ADJUSTMENT

3

-  Dark Gray - Long Cable
 Light Gray - Short Cable

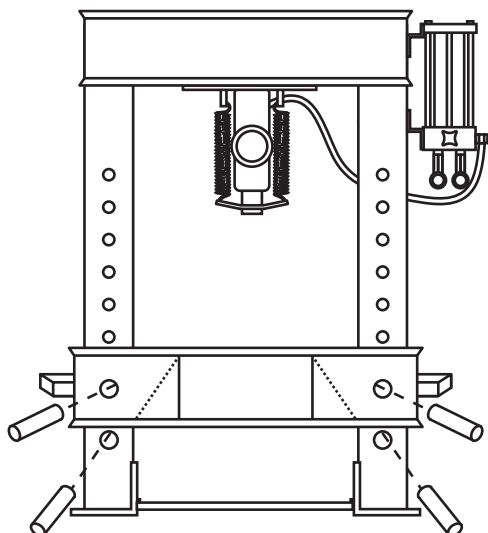

1. Move press bed into LOWEST position so it is resting on top of pins 1 and 2.

Right side of press,
under pump assembly

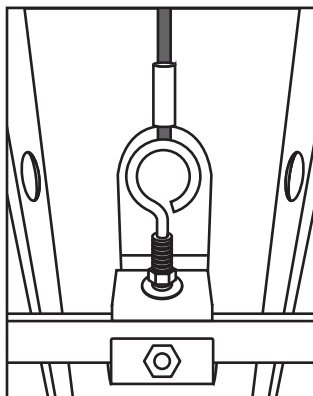

2. Install pre-attached eye bolt on LONGER cable to press bed handle located under pump assembly. **DO NOT FULLY TIGHTEN.** Center with side of press bed and make sure there is enough room to lower or raise both nuts on eye bolt for precise alignment.

⚠ WARNING

DO NOT FULLY TIGHTEN

Right side of press

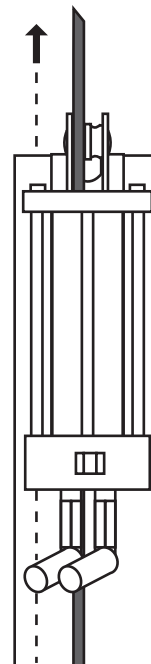

3. Thread the BARE end of the LONGER of the two steel cables up and through the pump bracket.

Note: Refer to manual from winch manufacturer for detailed instructions on winch assembly and cable threading procedure.

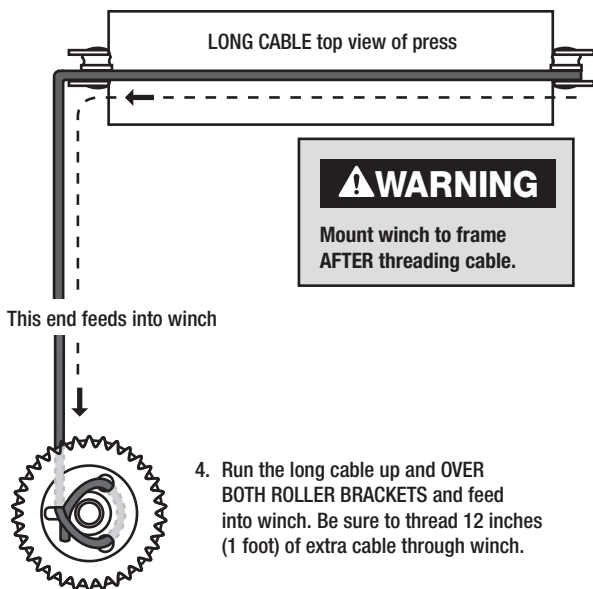

4. Run the long cable up and OVER BOTH ROLLER BRACKETS and feed into winch. Be sure to thread 12 inches (1 foot) of extra cable through winch.

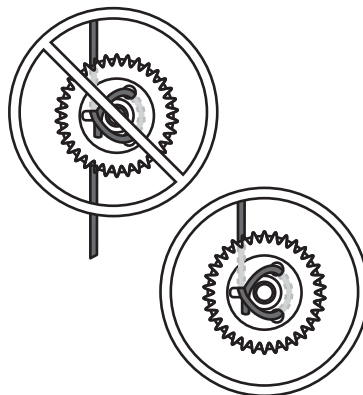

5. Once winch cable has been threaded, pull excess cable back through winch as shown in diagram above. The cable should be locked tightly around itself with no excess cable left hanging. Operate winch enough to remove slack from longer cable.

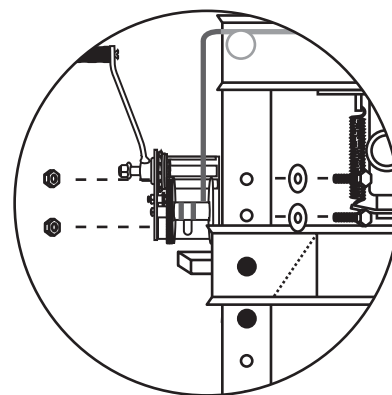

6. Mount winch to frame using the provided washers, 1/2" nuts and 1/2"-13 x 1-1/2" bolts.

WINCH CABLE ROUTING AND ADJUSTMENT (CONTINUED)

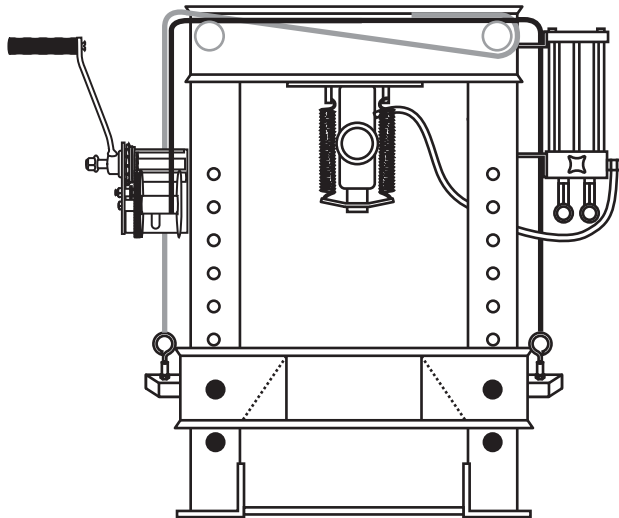

Top view of press with bed in lowest position

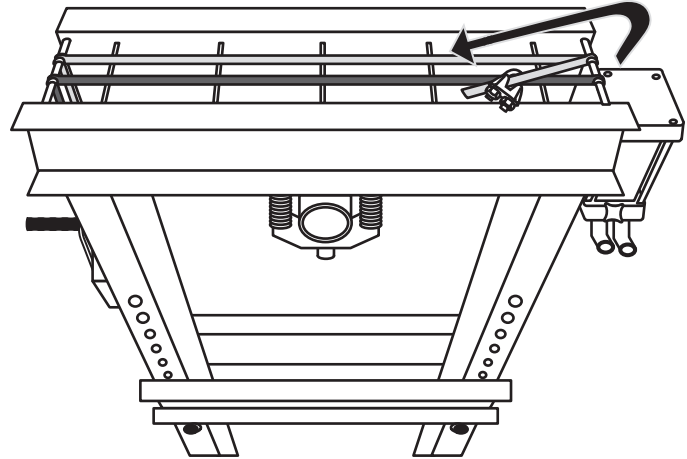

7. Feed the short cable by running it up and OVER first roller, then UNDER second roller. Loop the short cable back toward the winch and securely attach to the longer cable using the cable clamp. Remove slack from short cable before securing to long cable. Clamp should be NO LESS THAN ONE INCH (1") from roller.

Left side of press, under winch

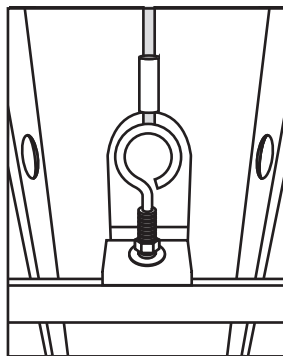

8. Install pre-attached eye bolt on SHORTER cable to press bed handle located under winch after feeding it around in step 7.
9. Turn eye hooks to adjust and level press bed. Once bed is level, firmly tighten eye hook mounting hardware. The steel cable will stretch with use. It may be necessary to repeat this leveling procedure in the future.
10. Test the winch kit by raising and lowering the press bed from its lowest to highest position. Repeat and adjust until bed is level and moves freely throughout its entire range of motion. Cut excess cable when all adjustments are complete.

REPLACEMENT PARTS LIST

Hydraulic Shop Press with Winch

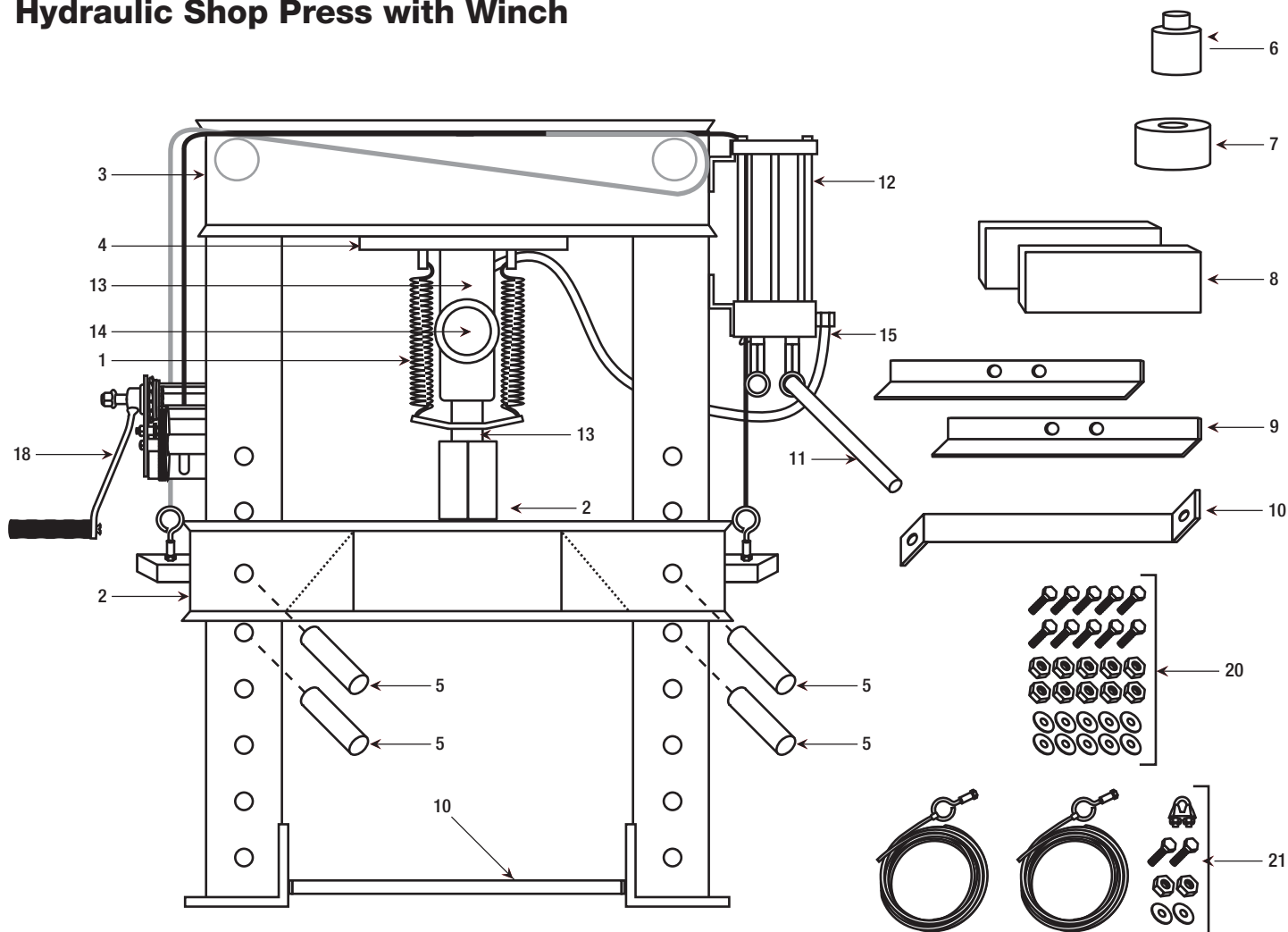

ITEM NO.	ITEM NO.	DESCRIPTION	QTY.	ITEM NO.	ITEM NO.	DESCRIPTION	QTY.
1	RSCBP1214	Ram Spring	2	16	RSCBP1201RVGG	Pump and Ram Assembly**	1
2		Press Bed	1	17	RSCBP1217	Seal Kit for Pump and Ram (not shown)	1
3		Press Frame	1	18	RS4050WCH	Winch	1
4		Ram Frame	1	20	RS40MPPHK	Press Hardware Kit	1 set
5	RSCBP1225	Press Pin	4			1/2"-13 x 1-1/2" Hex Head Bolt	10
6	RS310012	Pushing Adapter	1			1/2" Nut	10
7	RSBS1	Bearing Shield	1			Washer	10
8	RSCBP1205	Press Plate	2	21	RSWHK	Winch Hardware Kit	1 set
9	RSCBP1211	Press Feet	2			Cable Clamp	1
10	RSCBP1212	Z Bar	1			1/2"-13 x 1-1/2" Hex Head Bolt	2
11	RSCBP1209	Pump Handle	1			1/2" Nut	2
12	RSCBP1201BRV	Pump (includes handle)	1			Washer	2
13	RSCBP1202GG	Ram (includes gauge)	1			Short Cable (includes eye bolt)	1
14	RSCBP1206G	Liquid Filled Gauge	1			Long Cable (includes eye bolt)	1
15	RSCBP1204	Hose and Fitting	1				

****Pump and Ram Assembly includes pump, ram, gauge and hose and fitting (item numbers: 12 -15)**

PUMP AND RAM EXPLODED PARTS DIAGRAM

See Replacement Parts List for parts available separately.

Parts with (*) are only available in Seal Kit, part number RSCBP1217.

RAM

ITEM NO.	DESCRIPTION	QTY.
1	Base Weldment	1
2	Plug	1
3 *	Polypak Seal (Parker)	2
4	1/2-13 x 2 Hex HD C-S GR 2 Zinc	1
5	Piston	1
6 *	O-Ring (Parker)	1
7	Rod	1
8	Retaining Ring Int. 3.5 NOM	1
9	Piston Guide	1
10	Retractor Plate	1
11	Spring	2
12	Fitting Gauge 1.75	1
13	Gauge	1
14	90° Elbow 1/4 NPTF to -6 JIC	1
15	Hose Hydraulic	1
	41 1/2 LG 7/16-20 JICF	1

PUMP

ITEM NO.	DESCRIPTION	QTY.
1	Tank	1
2	Tie Rod	4
3	1" Piston Body	1
4	1/2" Piston Body	1
5	1" Piston	1
6	1/2" Piston	1
7	1/4" MNPT Pressure Plug	1
8	Pump Body	1
9	Pump Lid	1
10	Pump Bracket	2
11	Valve Assembly	1
12	Pivot Pin	2
13 *	5/16" Steel Ball	5
14	Brass Drain Cock	1
15	Cradle Assembly	2
16	Hydraulic Hose	1
	41-1/2" L 7/16-20 JICF	1
17	7/16-14 Fin Hex Nut Zinc	4
19 *	O-Ring	1
20 *	O-Ring	121
	3-1/2" Seal	2
22 *	3-5/16" Seal	1
23 *	3-3/16" Seal	1
24	SHCS 7/16 14 x 1/2"	4
25	SHCS 7/16 14 x 3/4"	4
26 *	Light Spring	2
27 *	Heavy Spring	2
28	7/16" Split Lock Washer	6
29	Pump Filter	1
30	Pump Fitting	1
	1/4" MNPT 7/16" JICF	1
31	7/8" Grip	1
32	Handle for Pump	1
33 *	O-Ring	1

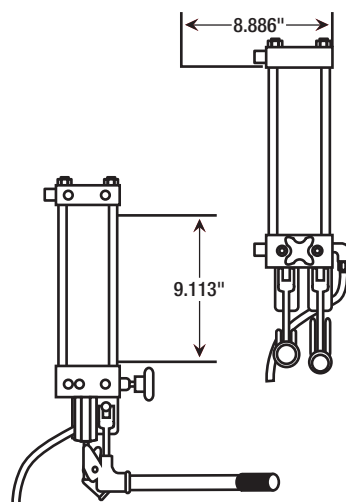
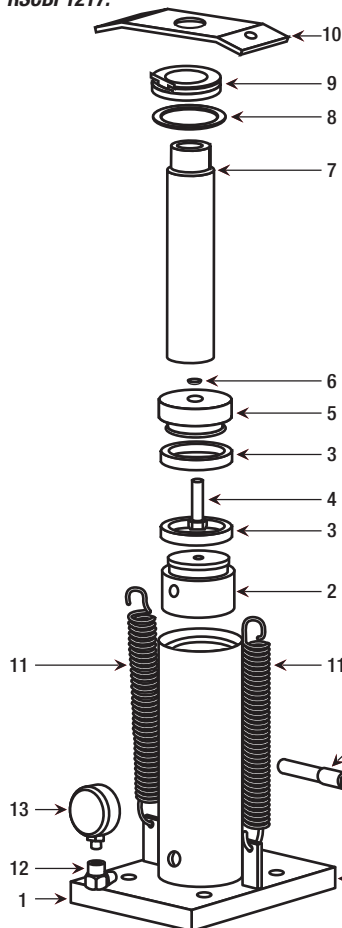

Individual parts pictured are components of the Seal Kit, RSCBP1217.

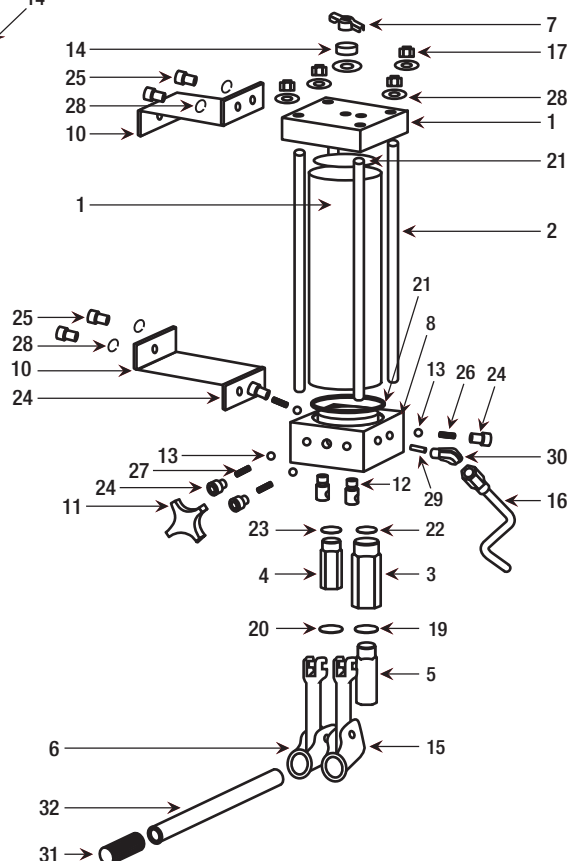
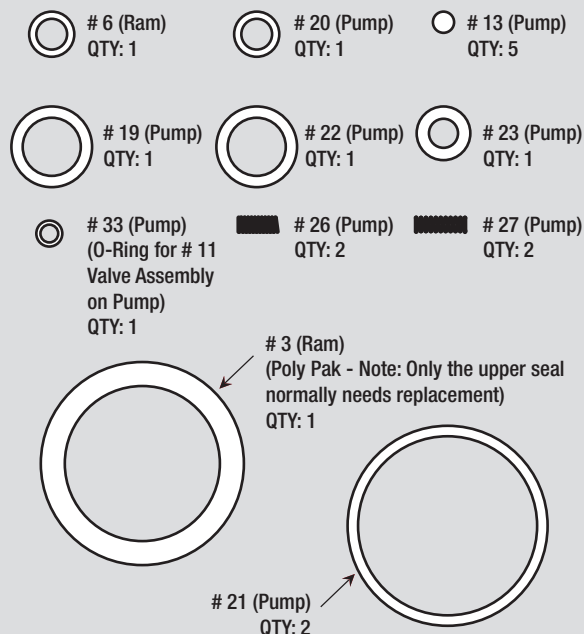

LIMITED WARRANTY

AMEREQUIPTM WARRANTS TO ITS CUSTOMERS THAT THE COMPANY'S AMEREQUIPTM BRANDED PRODUCTS ARE FREE FROM DEFECTS IN WORKMANSHIP AND MATERIALS.

AmerEquipTM will repair or replace its AmerEquipTM branded products which fail to give satisfactory service due to defective workmanship or materials, based upon the terms and conditions of the following described warranty plans attributed to that specific product.

This product carries a TWO-YEAR warranty. During this warranty period, AmerEquipTM will repair or replace at our option any part or unit which proves to be defective in material or workmanship.

Other important warranty information

This warranty does not cover damage to equipment or tools arising from alteration, abuse, misuse, damage and does not cover any repairs or replacement made by anyone other than AmerEquipTM or its authorized warranty service centers. The foregoing obligation is AmerEquip's sole liability under this or any implied warranty and under no circumstances shall we be liable for any incidental or consequential damages.

NOTE: Some states do not allow the exclusion or limitation of incidental or consequential damages, so the above limitation or exclusion may not apply to you.

Return equipment or parts to an authorized service center, transportation prepaid. Be certain to include your name and address, evidence of the purchase date, and description of the suspected defect. If you have any questions about warranty service, please write to AmerEquipTM. This warranty gives you specific legal rights and you may also have other rights which vary from state to state.

Repair kits and replacement parts are available for many of AmerEquipTM products regardless of whether or not the product is still covered by a warranty plan.

SHIPPING ADDRESS:

AmerEquipTM
315 Hawkins Rd.
Travelers Rest, South Carolina 29690

MAILING ADDRESS:

AmerEquipTM
P.O. Box 1233
Travelers Rest, South Carolina 29690