

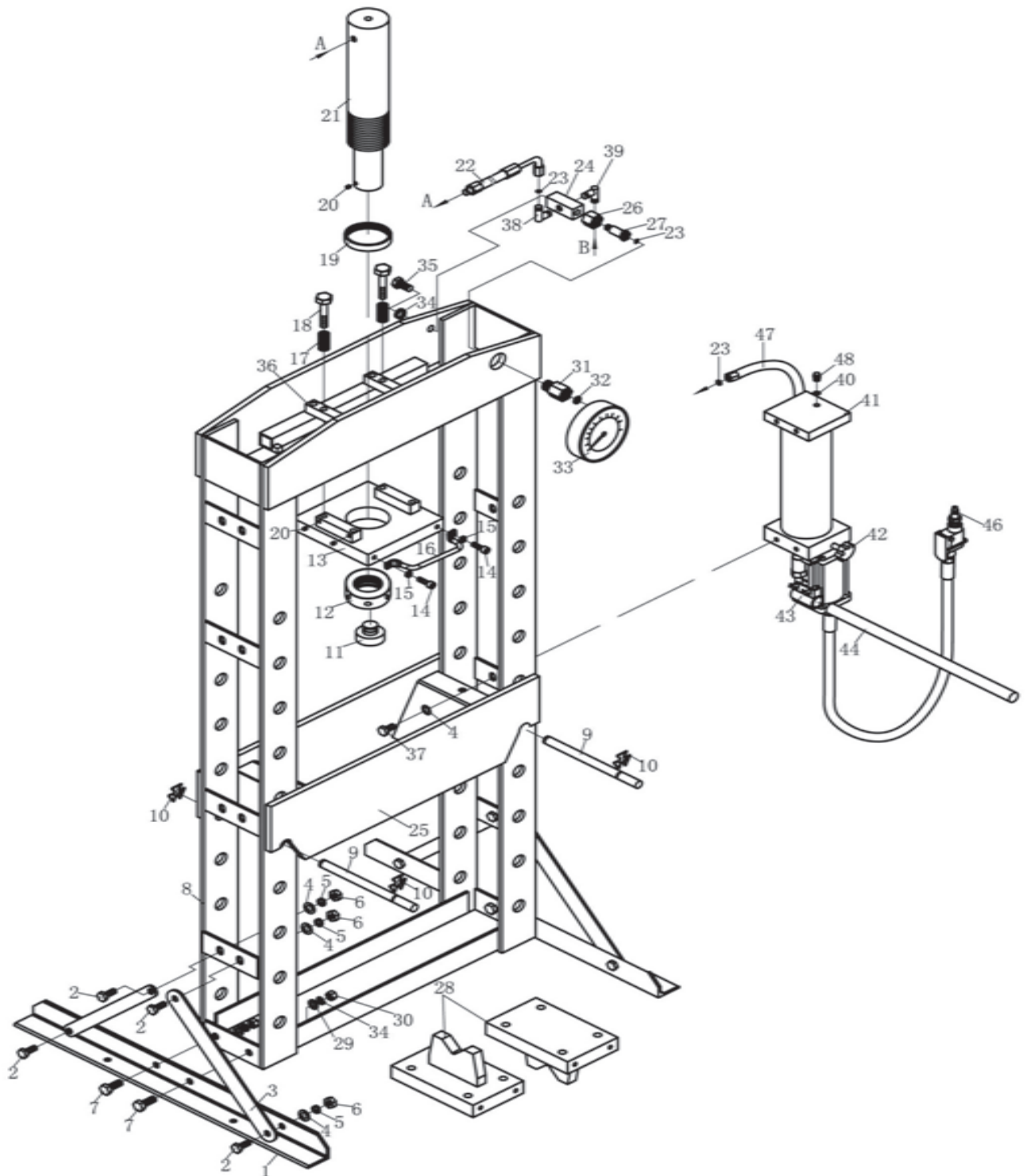

20 TON SUPER DUTY SHOP PRESS # 850SD





20 TON SUPER DUTY SHOP PRESS # 850SD

REF	PART NUMBER	DESCRIPTION	REQ	REF	PART NUMBER	DESCRIPTION	REQ
1	850SD-1	BASE SECTION	2	25	850SD-25	BED FRAME	1
2	850SD-HK	BOLT M10*25	8	26	850SD-26	NUT	1
3	850SD-3	SUPPORT	4	27	850SD-27	BANJO FIXING	1
4	850SD-HK	WASHER Ø10	12	28	850SD-28	HEEL BLOCK	2
5	850SD-HK	LOCK WASHER Ø10	8	29	850SD-29	WASHER Ø12	4
6	850SD-HK	NUT M10	8	30	850SD-30	NUT M12	4
7	850SD-HK	BOLT M12*30	4	31	850SD-31	GAUGE FITTING	1
8	850SD-8	BASE	1	32	850SD-32	NYLON RING	1
9	850SD-9	BED FRAME PIN	2	33	850SD-33	PRESSURE GAUGE	1
10	850SD-10	CIRCLIP	4	34	850SD-34	LOCK WASHER Ø12	5
11	850SD-11	SERRATED SADDLE	1	35	850SD-35	BOLT M12*25	1
12	850SD-12	UNDER ROUND NUT	1	36	850SD-36	LIND ROD	2
13	850SD-13	UNDER PLATE	1	37	850SD-HK	BOLT M10*25	4
14	850SD-14	SCREW	2	38	850SD-38	BANJO FIXING	1
15	850SD-15	LOCK WASHER	2	39	850SD-39	BANJO FIXING	1
16	850SD-16	HAND LEVER	1	40	850SD-40	NYLON RING	1
17	850SD-17	SPRING	4	41	850SD-41	PUMP ASSY	1
18	850SD-18	BOLT	4	42	850SD-42	RELEASE VALVE	1
19	850SD-19	UPPER ROUND RUT	1	43	850SD-43	HANDLE SOCKET	1
20	850SD-20	SCREW	5	44	850SD-44	HANDLE	1
21	850SD-21	RAM	1	45	850SD-45	BOLT	1
22	850SD-22	OIL HOSE	1	46	850SD-46	QUICK COUPLER- MALE	1
23	850SD-23	O-RING	3	47	850SD-47	OIL HOSE	1
24	850SD-24	BANJO FIXING	1	48	850SD-48	OIL FILLER NUT	1