



MODEL 3130 - 10 TON FLOOR JACK

1

UPDATED 9-05

PART ORDER NUMBER	KIT DESCRIPTION	KIT INCLUDES	
		REF. #	DESCRIPTION
3130K10	HANDLE COMPLETE	1.1	CAP
		1.2	COMPRESSION SPRING
		1.3	DEFLECTOR ROD
		1.4	SCREW ROD
		1.5	CONTROL ROD - HANDLE
3130K17	HANDLE RETAINER	1.6	WASHER
		1.7	BOLT
3130KHU	HYDRAULIC UNIT	3.1	FILTER
		3.2	WASHER
		3.3	OUTSIDE TUBE
		3.4	WASHER
		3.5	VALVE SEAT
		3.6	NEEDLE
		3.7	WIRE
		3.8	NUT
		3.9	SPRING
		3.10	SCREW ROD
		3.11	RUBBER RING
		3.12	RUBBER RING
		3.13	CYLINDER BODY
		3.14	PAPER WASHER
		3.15	COVER PLATE
		3.16	BOLT
		3.17	SCREW
		3.18	WASHER
		3.19	SEAL WASHER
		3.20	BOLT
		3.21	NUT
		3.22	CONNECTING BRUSH
		3.23	COTTER PIN
		3.24	CONNECTING ROD
		3.25	DRIVING ROD
		3.26	COTTER PIN
		3.27	PIN
		3.28	PISTON ROD
		3.29	LOCKING NUT
		3.30	DUST RING
		3.31	STOP RING
		3.32	SEAL RING
		3.33	BUSH PREVENT RING
		6.3	SEAL RING
		6.4	LARGE NUT
		6.4A	DUST PROOF RING
		6.5	RING
		6.6	WASHER
		6.7	BUSHING
		6.8	SEAL RING

continued

**ONLY PARTS WITH A "PART ORDER NUMBER" ARE AVAILABLE FOR SALE.
DO NOT COPY OR DISTRIBUTE THIS MATERIAL WITHOUT PERMISSION OF AFF, INC.**



MODEL 3130 - 10 TON FLOOR JACK

2

UPDATED 9-05

PART		KIT INCLUDES	
ORDER NUMBER	KIT DESCRIPTION	REF. #	DESCRIPTION
continued			
3130KHU	HYDRAULIC UNIT	6.9	PISTON
		6.10	RUBBER CUP
		6.11	STOP RING
		6.12	SPRING
		6.13	PISTON ROD
		6.14	STEEL BALL
		6.15	PUSH NEEDLE
		6.16	VALVE SEAT
		6.17	SCREW
		6.18	SPRING
		6.20	OUTER BODY
		6.22	STEEL BALL
		6.23	SMALL PUSH ROD
		6.24	STEEL BALL
		6.25	LARGE BALL ROD
		6.26	WASHER
		6.27	BOLT
		6.28	STEEL BALL
		6.29	VALVE SEAT
		6.30	SPRING
		6.31	STOP BLOCK
		6.32	SCREW
		6.33	SEAL RING
		6.34	SCREW
		6.35	WASHER
3130K40	CASTER COMPLETE	4.1	COVER
		4.2	WHEEL COVER
		4.3	GREASE FITTING
		4.4	WASHER
		4.5	SCREW
		4.6	BEARING COVER
		4.7	STEEL BALL
		4.8	BEARING HOLDER
		4.9	WHEEL FORK
		4.10	WHEEL
		4.11	RIVET
3130K50	FRONT WHEEL COMPLETE	5.3	STOP RING
		5.4	WHEEL
		5.5	GREASE FITTING
		5.6	ROLLER (13)
		5.7	STOP RING
		5.8	SPLIT RING
3130K71	SADDLE	7.1	SADDLE

ONLY PARTS WITH A "PART ORDER NUMBER" ARE AVAILABLE FOR SALE.
DO NOT COPY OR DISTRIBUTE THIS MATERIAL WITHOUT PERMISSION OF AFF, INC.



MODEL 3130 - 10 TON FLOOR JACK

3

UPDATED 9-05

PART ORDER NUMBER	KIT DESCRIPTION	KIT INCLUDES	
		REF. #	DESCRIPTION
3130KRK	REPAIR KIT	3.11	RUBBER RING
		3.12	RUBBER RING
		3.14	PAPER WASHER
		3.18	SEAL WASHER
		3.19	SEAL WASHER
		3.30	DUST RING
		3.31	STOP RING
		3.32	SEAL RING
		3.33	BUSH PREVENT RING
		6.3	SEAL RING
		6.4A	DUST PROOF RING
		6.6	O-RING-TWO REQUIRED
		6.8	SEAL RING
		6.10	RUBBER CAP
		6.11	STOP RING
		6.14	STEEL BALL
		6.22	STEEL BALL
		6.24	STEEL BALL
		6.26	SEAL WASHER
		6.28	STEEL BALL
		6.30	SPRING
		6.33	SEAL RING
3130K29	CAP SET	2.1	FOOT PEDAL
		2.2	CIRCLIP
		2.3	PIN
		2.4	FORK MEMBER
		2.5	BUSH
		2.6	BASE
		2.8	PIN
		2.9	CAP
		2.10	SHAFT
		2.11	SCREW
		2.12	WASHER
		2.13	WASHER
		2.14	CLAMP RING
		3.24	CONNECTING ROD
NOT AVAILABLE		5.1	AXLE
NOT AVAILABLE		5.2	NUT
NOT AVAILABLE		6.1	JOINT
NOT AVAILABLE		6.2	SCREW
NOT AVAILABLE		7.2	SADDLE CARRIER
NOT AVAILABLE		7.3	AXLE
NOT AVAILABLE		7.4	LEVEL SUPPORTING ROD
NOT AVAILABLE		7.5	AXLE
NOT AVAILABLE		7.6	ROCKER
NOT AVAILABLE		7.7	BOLT
NOT AVAILABLE		7.8	AXLE

ONLY PARTS WITH A "PART ORDER NUMBER" ARE AVAILABLE FOR SALE.
DO NOT COPY OR DISTRIBUTE THIS MATERIAL WITHOUT PERMISSION OF AFF, INC.



MODEL 3130 - 10 TON FLOOR JACK

4

UPDATED 8-05

PART ORDER NUMBER	KIT DESCRIPTION	KIT INCLUDES	
		REF. #	DESCRIPTION
NOT AVAILABLE		7.9	AXLE
NOT AVAILABLE		7.10	GREASE FITTING
NOT AVAILABLE		8.1	COVER PLATE
NOT AVAILABLE		8.2	SIDE PLATE
NOT AVAILABLE		8.3	RIVET
NOT AVAILABLE		8.5	SCREW
NOT AVAILABLE		8.6	WASHER
NOT AVAILABLE		8.7	NUT
NOT AVAILABLE		8.8	NUT
NOT AVAILABLE		8.9	WASHER
NOT AVAILABLE		8.10	LIMITER AXLE

ONLY PARTS WITH A "PART ORDER NUMBER" ARE AVAILABLE FOR SALE.
DO NOT COPY OR DISTRIBUTE THIS MATERIAL WITHOUT PERMISSION OF AFF, INC.

MODEL# 3130

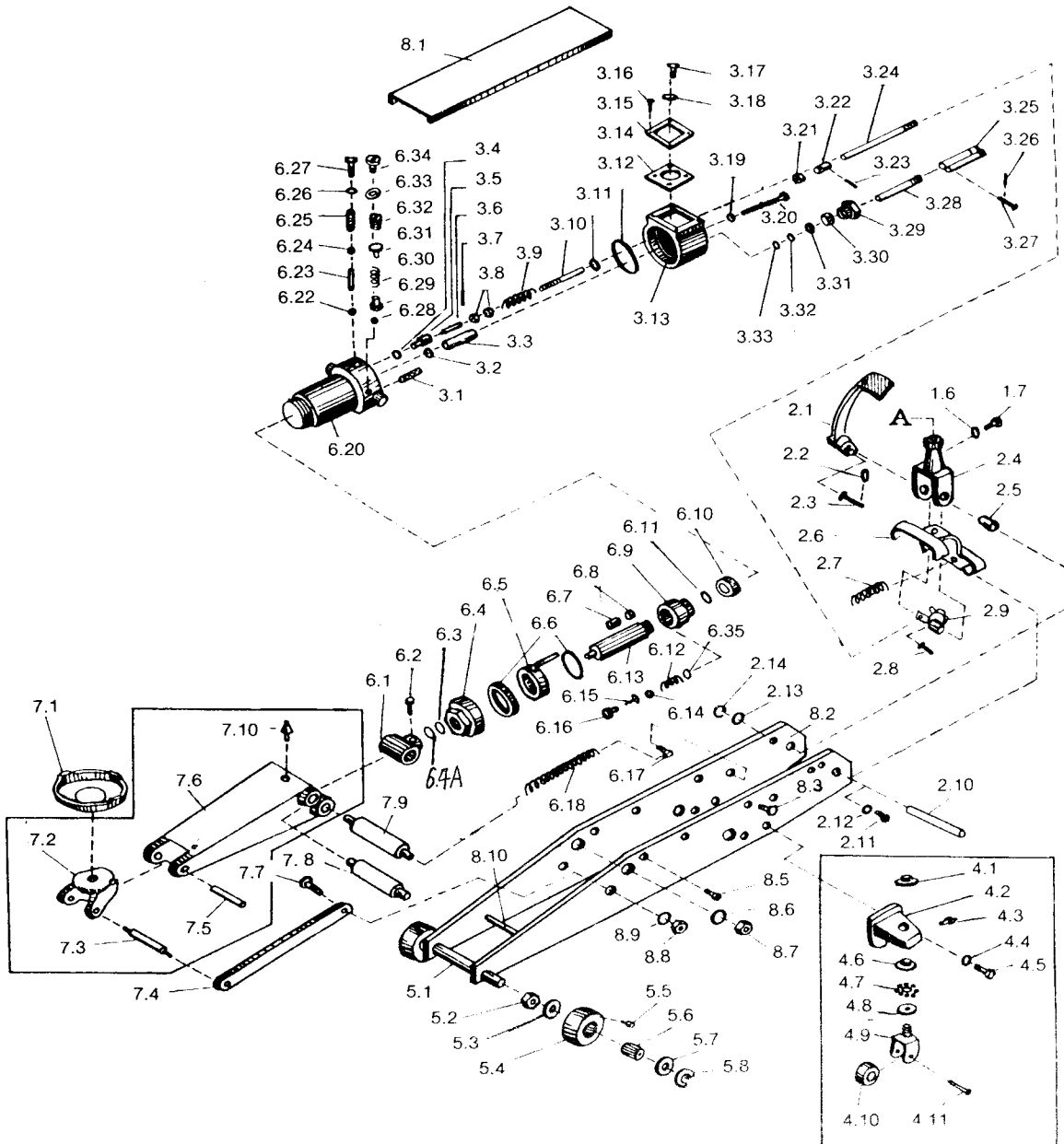

DO NOT COPY OR DISTRIBUTE THIS MATERIAL WITHOUT PERMISSION OF AFF, INC.