

**WALKER**

# TRANSMISSION JACK

HIGH LIFT, HYDRAULIC  
1/4 TON CAPACITY



**Model 93714**

**SERIES "C"**

SOME PARTS STILL AVAILABLE

KIT # URK80

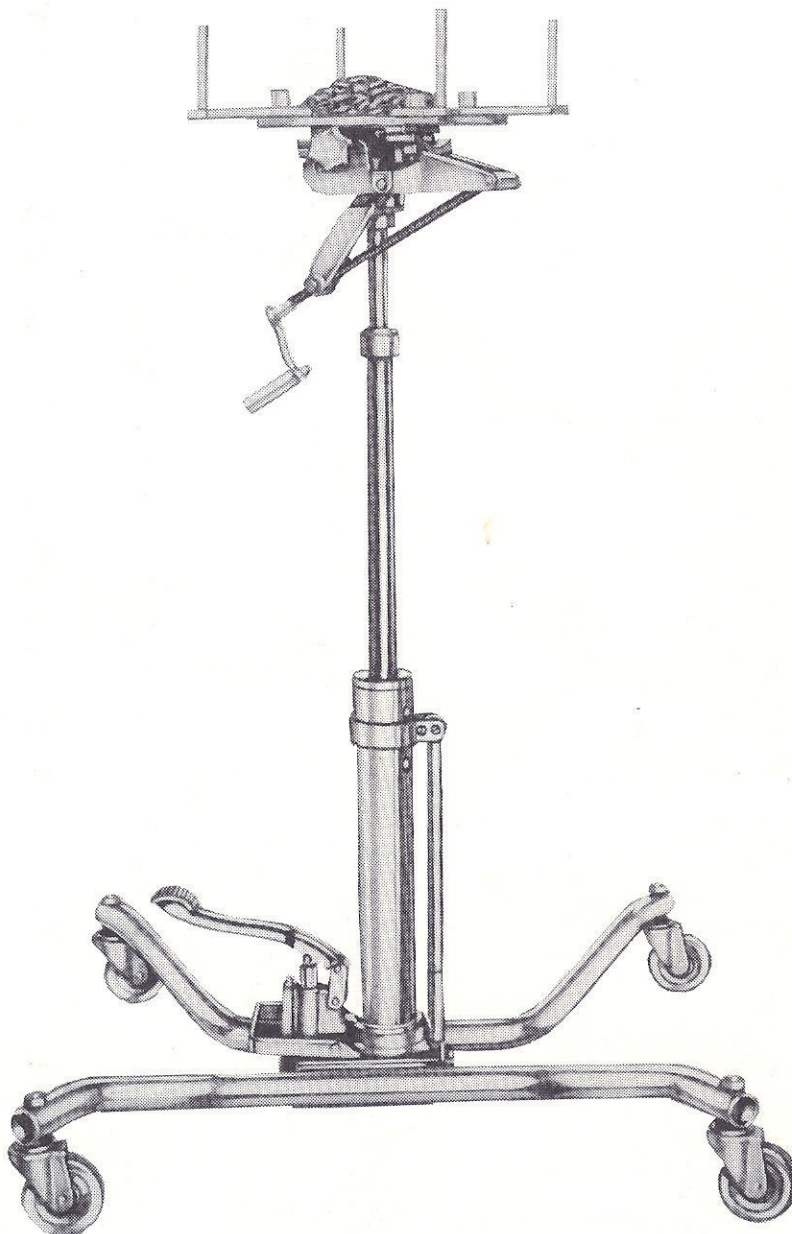

**LINCOLN ST. LOUIS**



A DIVISION OF  
**McNEIL**  
CORPORATION

SECTION - **W3**  
PAGE - **2C**

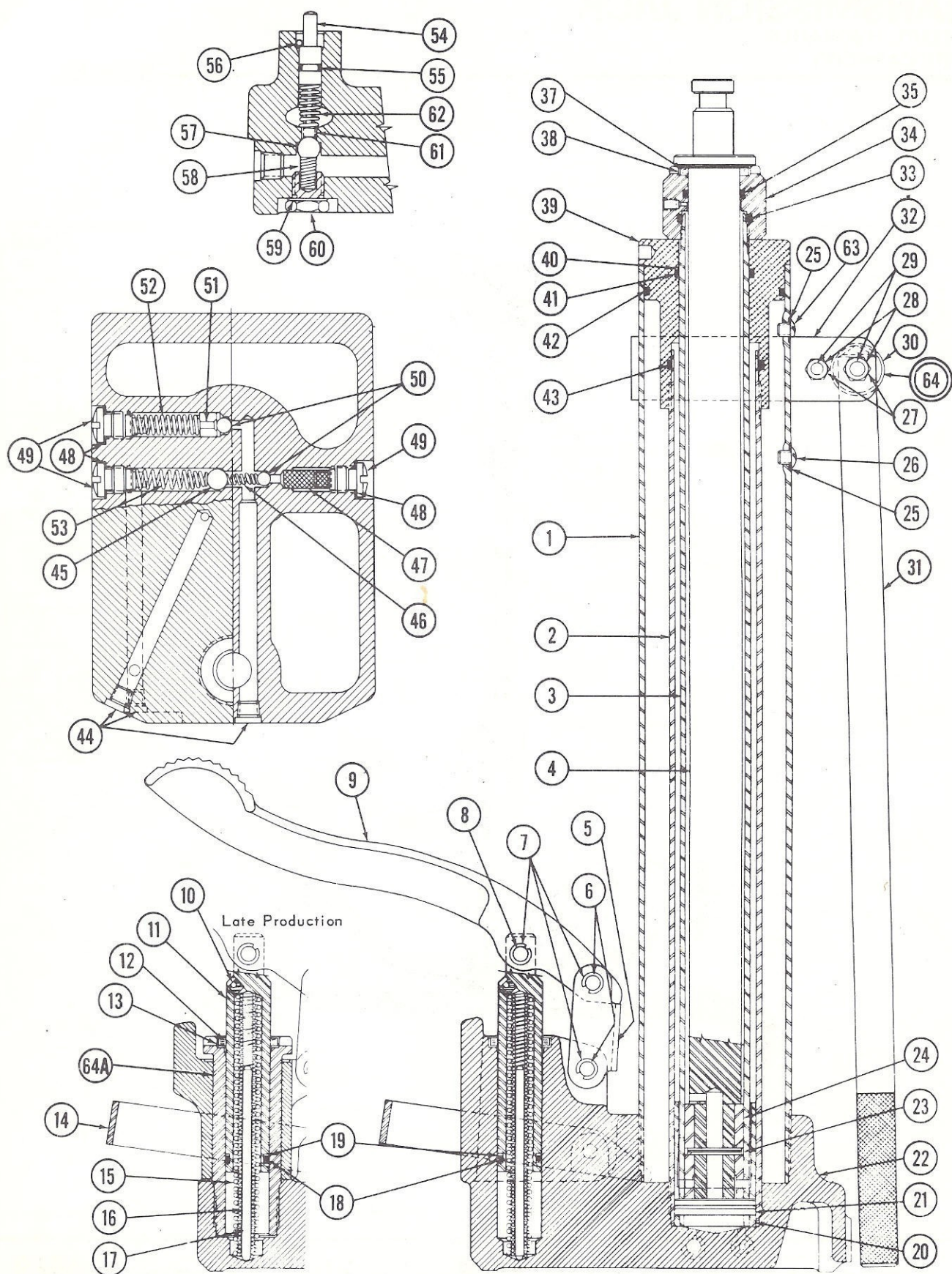

**NOTE** - When new base is required, order P/N 225380 and add P/N 225382 pump cylinder. Early production base and pump cylinder were one piece. Late production has removable pump cylinder.