

BLACKHAWK®

Master Copy
repair parts

MODELS T-3-1 & T-3-2 TRANSMISSION JACK

RATED CAPACITY — ½ TON

Issued August, 1965 — Supersedes Sheet PS-292

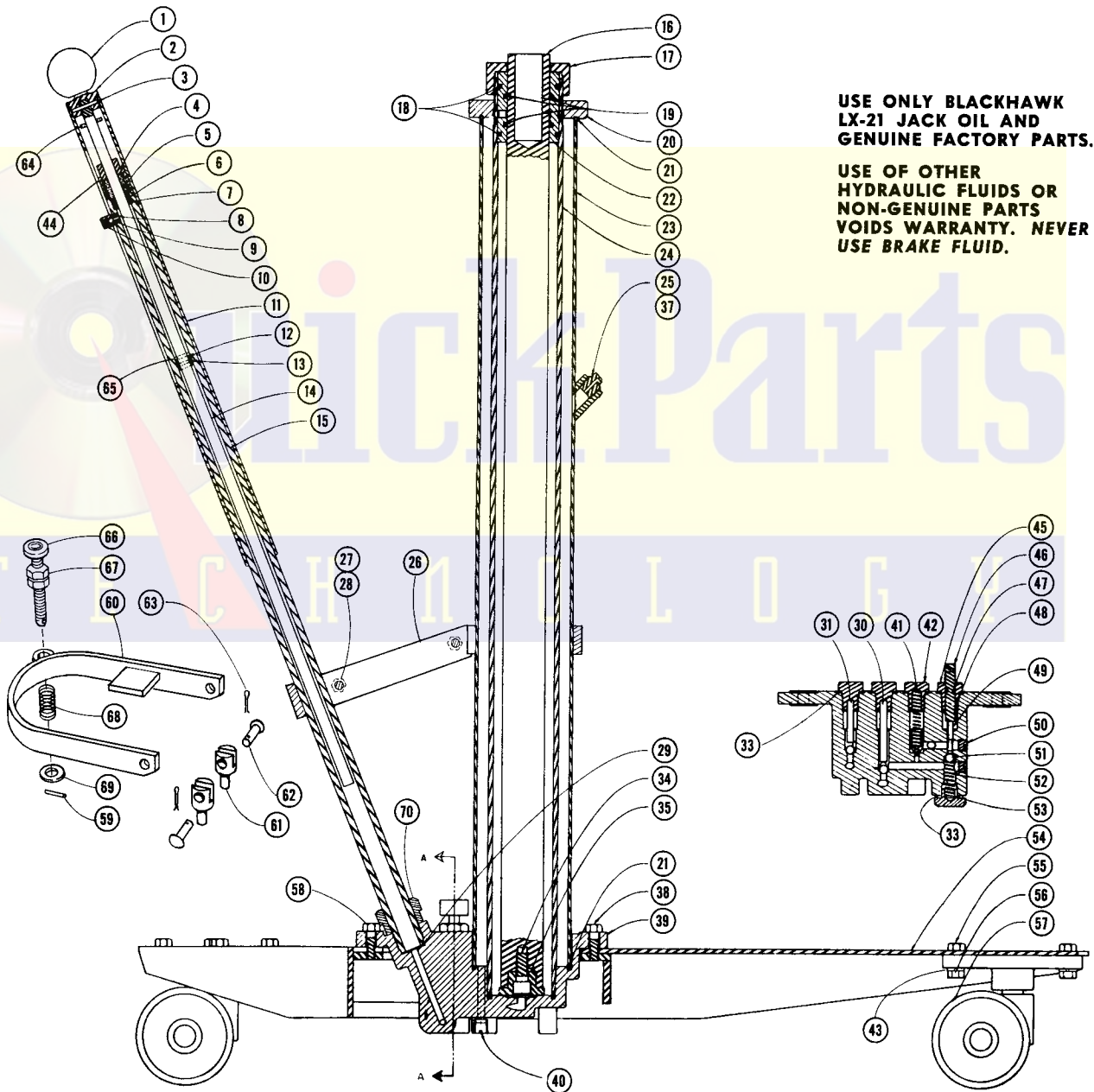

T-3-1 HAD THREE ARM FRAME ASSEMBLY PART NO. D383.001
T-3-2 HAS FOUR ARM FRAME ASSEMBLY PART NO. D210.001
D210.001 REPLACES D383.001 AND IS INTERCHANGEABLE

REPAIR PARTS LIST FOR MODELS T-3-1 & T-3-2

Item No.	Part No.	No. Req.	Description	Item No.	Part No.	No. Req.	Description
1	P60.308	1	Knob	44	E710.108	1	Wave Washer
2	D134.151	1	Plunger Anchor	45	D139.039	1	Bushing
3	D374.061	1	Roll Pin	46	D140.040	1	Release Plunger
4	D158.055	1	Nut	*47	B709.503	1	"O" Ring
5	D157.039	1	Bushing	48	D153.044	1	Retaining Ring
* 6	D131.033	3	Chevron (Rubber)	49	D141.061	1	Release Pin
7	D137.044	1	Spreader	50	D190.006	5	1/16"-27 Pipe Plug
8	D159.165	1	Valve Body	*51	W12.16	4	Ball
9	1.16	1	7/32" Ball	*52	D154.183	1	Spring
10	D161.006	1	Plug	53	D167.006	1	Valve Plug
11	D658.039	1	Sleeve	54	D210.001	1	Frame
12	D136.044	1	Stop Ring	55	W4.488	16	Cap Screw
13	D674.061	1	Roll Pin	56	B954.055	16	Nut
14	D135.040	1	Pump Plunger	57	D198.154	4	Caster
15	D156.030	1	Pump Cylinder	58	SJ100.123	3	Cap Screw
16	D637.040	1	Plunger	59	D184.061	1	Roll Pin
17	D638.055-1	1	Top Nut	60	D163.218	1	Treadle
*18	D146.041	2	"O" Ring	61	D162.151	2	Swivel
*19	D196.041	2	"O" Ring	62	D164.061	2	Pin
20	D640.055	1	Top Cap	*63	S1.58	2	Cotter Pin
*21	D145.041	2	"O" Ring	*64	5.75	1	Packing
22	D641.039	1	Bushing	*65	B710.503	1	"O" Ring
23	D642.025	1	Reservoir	66	D185.028	1	Adjusting Screw
24	D643.030	1	Cylinder	67	MJ.35	2	Nut
25	D148.006	1	Plug (Vented)	68	D183.183	1	Spring
26	D644.111	1	Bracket	69	W40.108	1	Washer
27	SJ100.125	2	Nut	70	D662.055	1	Nut
28	D188.028	2	Cap Screw	**71	D906.268	1	Sump Tube
*29	D669.041	1	Gasket	**72	E287.900	1	Pump Assembly
30	D908.900	1	Plug & Pin Assembly				Includes Items (1) thru (15) and
31	D905.900	1	Plug & Pin Assembly				Items 44, 64, 65
*33	D144.167	5	Gasket	**73	B155.026-1	1	Name Plate
34	D189.028	1	Cap Screw	**74	E464.026	1	Decal (T3)
35	D195.013	1	Plunger Stop	**75	W78.03	2	Drive Screw
**37	D149.006	1	Plug (Shipping)				
38	E73.028	1	Cap Screw				
†39	D130.005	1	Base				
40	D99.006	3	1/8-27 Pipe Plug				
*41	D151.183	1	Spring				
42	E81.006	1	Valve Plug				
43	D216.108	16	Lock Washer				

*For economy repair use Jack/Saver Kit T3K-3
Items included in this kit are marked with an asterisk (*).

**Items not shown

†For power unit base assembly order D130.900

NOTE: Orders for parts cannot be filled unless both model and serial number with prefix imprinted on nameplate are given.

FRANCHISED SERVICE DEPOTS



official sign are backed with full factory guarantee. The Classified Section in your Phone Book lists your nearest Franchised Service Depot.

For quality workmanship and genuine Blackhawk parts select a Franchised Blackhawk Service Depot for your repair work. Only repairs performed by a Franchised Service Depot displaying this

GUARANTEE

Blackhawk guarantees its Products against defects in workmanship and materials for 90 days from date of delivery to the user. Only exception is chain, which follows the trade custom of its manufacturers and cannot be guaranteed. When question of warranty arises, the user should send his unit to the nearest Blackhawk Franchised Service Depot for inspection, transportation to be prepaid and evidence of purchased date furnished. If the difficulty comes under the terms of our guarantee, the Franchised Service Depot will repair or replace parts affected and return prepaid. Our guarantee does not cover ordinary wear and tear, abuse, misuse, overloading, altered products or use of improper fluid.

PARTS, SERVICE INFORMATION AND THE ADMINISTRATION OF FRANCHISED SERVICE DEPOTS FOR BLACKHAWK PRODUCTS IS PROVIDED BY —

BLACKHAWK SERVICE

MILWAUKEE, WISCONSIN 53246

DIVISION OF APPLIED POWER INDUSTRIES, INC.

Please direct all Service Correspondence to BLACKHAWK SERVICE