

Master Copy

BLACKHAWK®

REPAIR PARTS SHEET
ELECTRIC
ONE END LIFT
MODEL SJ-75
RATED CAPACITY
1½ TONS
Sheet No. S-163
Issued Sept., 1959

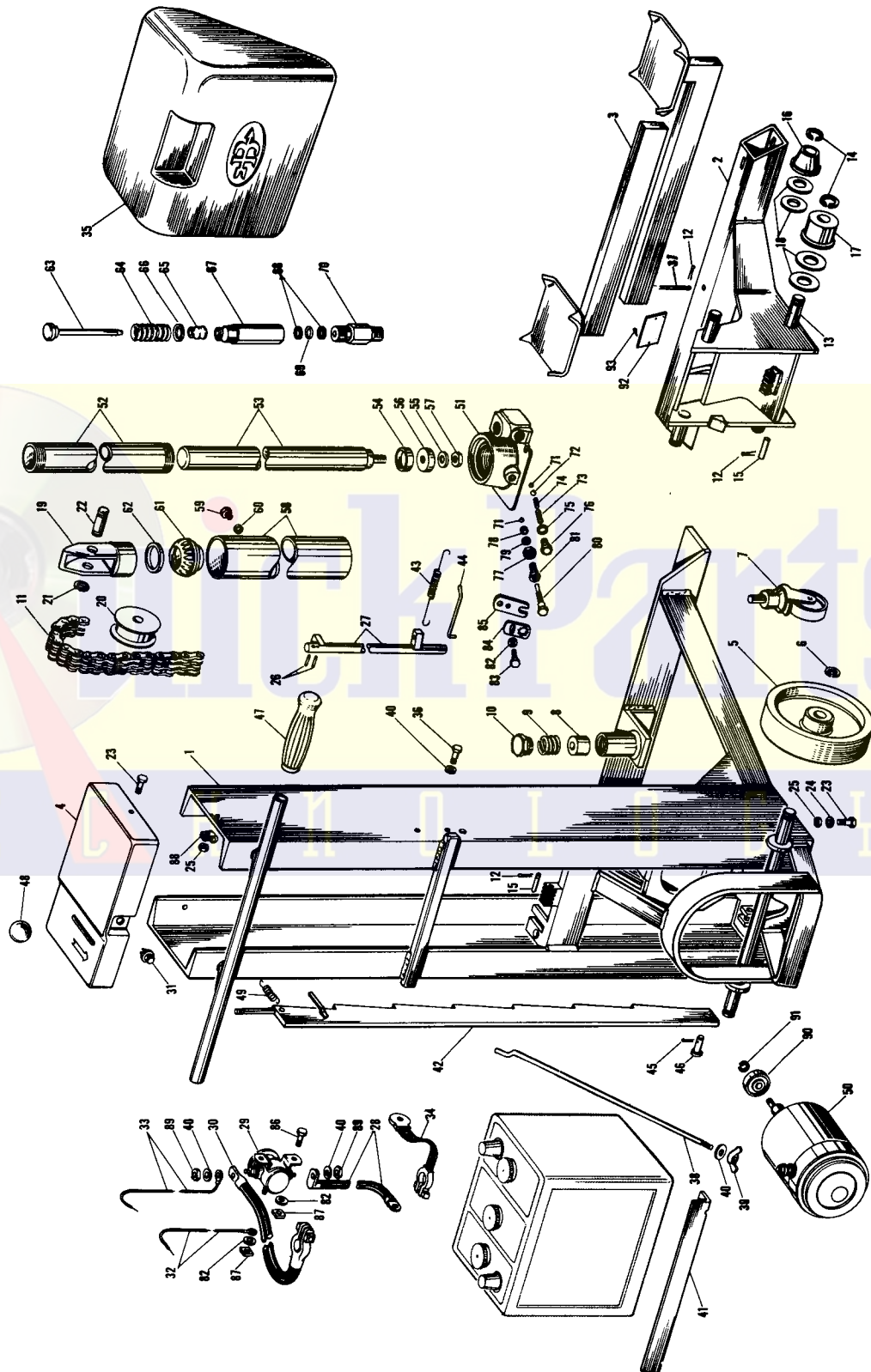

REPAIR PARTS SHEET FOR SJ-75
ELECTRIC ONE END LIFT

Parts List on Reverse Side



PARTS LIST FOR MODELS SJ-75

Item No.	Part No.	Description	Qty.	Item No.	Part No.	Description	Qty.
1	SJ10.086	Chassis Weldment	1	49	SJ100.082	Ratchet Return Spring	1
2	SJ10.094	Elevator	1	50	SJ100.326	Motor Assembly	1
3	SJ10.051	Lift Arm	2	51	A133.005	Base	1
4	SJ100.325	Hood	1	52	A138.030	Cylinder	1
5	SJ100.349	Wheel	2	53	A139.040	Plunger	1
6	SJ100.090	Snap Ring	2	54	BA85.29-3	Plunger Ring	1
7	SJ100.085	Caster	1	55	CJ100.030	Plunger Cup Washer	1
8	SJ100.053	Caster Plunger	1	56	1.41-1	Plunger Cup	1
9	SJ100.086	Caster Spring	1	57	MJ-35	Plunger Cup Nut	1
10	SJ100.052	Retaining Nut	1	58	SJ100.357	Reservoir	1
11	SJ100.066	Elevator Chain	1	59	AJ10.055	Reservoir Plug Assembly	1
12	AJ100.032	Cotter Pin	3	60	C9.37	Reservoir Plug Gasket	1
13	SJ100.021	Roller Shaft (included with item 2)	4	61	CJ100.106	Top Cap	1
14	SJ100.069	Roller Shaft Snap Rings	4	62	CJ100.104	Quad Ring (included with item 61)	1
15	SJ100.073	Clevis Pin	2	63	AJ10.053	Pump Plunger & Cap	1
16	SJ100.018	Upper Roller	2	64	SJ100.346	Pump Plunger Spring	1
17	SJ100.017	Lower Roller	2	65	SJ100.344	Plunger Boot	1
18	SJ100.087	Thrust Washer	8	66	SJ100.345	Pump Washer	1
19	SJ100.096	Trunnion	1	67	SJ100.330	Pump Body Cap	1
20	SJ100.031	Chain Sheave	1	68	SJ100.347	Back Up Ring	2
21	SJ100.070	Snap Ring	2	69	SJ100.348	"O" Ring	1
22	SJ100.034	Sheave Shaft	1	70	SJ100.331	Pump Body	1
23	SJ100.078	Cap Screw	4	71	1.16	7/32" Ball	2
24	SJ100.098	Washer	2	72	S1.16	5/16" Ball	1
25	SJ100.079	Lock Nut	4	73	SJ100.340	Ball Spring-Outer	1
26	SJ100.071	Roll Pin	2	74	SJ100.339	Ball Spring-Inner	1
27	SJ10.011	Release Mechanism Assembly	1	75	B159.167	Valve Plug Gasket	1
28	SJ100.335	Cable (Motor to Sol.)	1	76	CB9.185-2	Valve Plug	1
29	SJ100.336	Starter Relay (Solenoid)	1	77	AJ100.218	Pal Nut	1
30	SJ100.341	Cable (Sol. to Batt.)	1	78	CB9.335	Leather Washer	1
31	SJ100.343	Starter Button	1	79	1.74	Release Valve Packing	1
32	SJ100.350	Switch Wire (Center)	1	80	SJ100.302	Release Valve Spindle	1
33	SJ100.351	Switch Wire (Top)	1	81	SJ100.095	Release Valve Packing Nut	1
34	SJ100.342	Cable (Batt. to Grd.)	1	82	SJ100.169	Washer	4
35	SJ100.358	Battery Cover	1	83	AJ100.293	Screw	1
36	AJ100.231	Cap Screw	1	84	AJ100.289	Release Valve Arm	1
37	SJ100.049	Stop Pin	1	85	AJ100.290	Release Valve Arm Extension	1
38	SJ100.338	Hook Bolt	2	86	SJ100.170	Cap Screw	2
39	AJ100.294	Wing Nut	2	87	SJ100.105	Square Nut	3
40	SJ100.289	Washer	5	88	SJ100.300	Wiring Clip	1
41	SJ100.337	Battery Clamp	1	89	AJ100.301	Hex Nut	2
42	SJ10.096	Safety Ratchet	1	90	SJ100.334	Bearing	1
43	SJ100.083	Release Return Spring	1	91	SJ100.333	Snap Ring	1
44	SJ100.047	Release Pull Rod	1	92	SJ100.364	Nameplate	1
45	SJ100.008	Cotter Pin	1	93	AJ100.001	Drive Screw	2
46	SJ100.072	Safety Ratchet Pin	1	*	SJ100.387	Decal	1
47	SJ100.075	Handle Grip	2	*	SJ100.301	Decal (Batt. Inst.)	1
48	SJ100.074	Safety Ratchet Knob	1	*	SJ100.246	"Blackhawk" Decal	1

Assemblies			
AJ10.054	Release Valve Arm	1	
(consists of item 82, 83, 84, 85)			
SJ10.021	Trunnion Assembly	1	
(consists of items 19, 20, 21, 22)			
SJ10.042	Pump Unit	1	
(consists of items 63 thru 70)			
*Not Shown			

NOTE: Orders for parts cannot be filled unless both model and serial number with prefix, imprinted on nameplate of ram, are given.

GUARANTEE

Blackhawk guarantees its Hand Jacks, Service Jacks and Porto-Power against defects in workmanship and material for 90 days from date of delivery to the user. Only exception is Porto-Power chain, which follows the trade custom of its manufacturers and cannot be guaranteed.

When question of warranty arises, the user should send his unit to the nearest Blackhawk Franchised Service Depot for inspection, or to the Blackhawk Service Division, 5054 W. State St., Milwaukee 8, Wis.; transportation to be prepaid and evidence of delivery date furnished.

If the difficulty comes under the terms of our guarantee, we will repair or replace parts affected and return prepaid. Our guarantee does not cover ordinary wear and tear, abuse, misuse, overloading, altered products or use of improper fluid.

A Network of FRANCHISED SERVICE DEPOTS serves Blackhawk Users worldwide

For quality workmanship with genuine Blackhawk parts select a franchised Blackhawk Service depot for your repair work. Only repairs performed by a franchised service depot are backed with full factory guarantee. The Classified Section in your Phone Book lists your nearest Franchised Service Depot.

BLACKHAWK MFG. CO. - - - MILWAUKEE 46, WIS.