

BLACKHAWK®

instructions & repair parts

MODEL SJ-26-E HYDRAULIC ONE-END LIFT RATED CAPACITY — 1½ TONS AND MODEL SJ-1030 HI-LIFT KIT

Issued August, 1965 — Supersedes Sheet PS-293

Your Blackhawk One-End Lift is a high quality precision-built unit that will give you many years of trouble-free service. Like all mechanical devices, however, it does require proper handling and care.

POSITIONING

1. Using the handle bar, tip the jack back and push it to the job.
2. Set the adjustable lifting arms so that the saddles will contact the bumper, bumper brackets, or lifting pads depending upon automobile to be lifted. Whenever possible, lift by the bracket or pads. These are the strongest supports for the car.
3. For best operation — ROLL into position so that lifting saddles are centered on bumper brackets, lifting pads or lower bumper lip.

LIFTING

1. Do not set brakes of automobile when using the end lift.
2. When the jack is positioned, approach the load by rapidly pumping the quick-lift yoke. When load is engaged, insert the handle into yoke and pump until vehicle is high enough for service operation. Remove handle and replace on stowage pin.

LOWERING

To lower the load, lift the release lever. Letting go of the release lever will stop the load instantaneously. It's spring loaded for ease and safety so you can control it all the way.

OIL LEVEL CHECK

If jack will not lift load check the oil level in the hydraulic unit as follows:

1. Depress elevator to its lowest position.
2. Remove filler plug and fill with Blackhawk LX-21 Hydraulic Oil until fluid starts to run out (lower lip of filler hole is proper oil level). **DO NOT FILL ABOVE THIS LEVEL** — or hydraulic jack will not function properly.
3. Replace filler plug and gasket and tighten firmly.

LUBRICATION

Under normal operating conditions the mechanical parts of your end lift should be oiled every 60 days. For heavy usage and use on wash racks, oil more frequently.

Use a good grade of SAE #20 Motor Oil. Oil freely the pumping handle bearings, guide rollers, wheels, adjustable lifting arm slides and all linkage joints.

Checking all items of equipment every 60 days has proved to be a cost saving practice.

RELEASE VALVE ADJUSTMENT

After prolonged service it may be necessary to make a simple readjustment of the release valve. The need for this readjustment is indicated when the jack will not lift the load or jack will not hold the load, providing oil level has been checked as outlined above.

1. Remove rear cover from unit.
2. Disconnect release valve return spring.
3. Loosen hex clamp screw on release valve arm assembly.
4. Turn release valve arm clockwise with fingers to seat release valve spindle firmly. **WARNING: DO NOT FORCE.** If it cannot rotate far enough to seat spindle, remove hex clamp screw, seat valve spindle, remove release valve arm and reposition it on the hex head of spindle to horizontal 30°.

Replace clamp screw in assembly and tighten securely.
5. Replace return spring and rear cover.

FRANCHISED SERVICE DEPOTS



For quality workmanship and genuine Blackhawk parts select a Franchised Blackhawk Service Depot for your repair work. Only repairs performed by a Franchised Service Depot displaying this official sign are backed with full factory guarantee. The Classified Section in your Phone Book lists your nearest Franchised Service Depot.

GUARANTEE

Blackhawk guarantees its Products against defects in workmanship and materials for 90 days from date of delivery to the user. Only exception is chain, which follows the trade custom of its manufacturers and cannot be guaranteed. When question of warranty arises, the user should send his unit to the nearest Blackhawk Franchised Service Depot for inspection, transportation to be prepaid and evidence of purchased date furnished. If the difficulty comes under the terms of our guarantee, the Franchised Service Depot will repair or replace parts affected and return prepaid. Our guarantee does not cover ordinary wear and tear, abuse, misuse, overloading, altered products or use of improper fluid.

HI-LIFT KIT

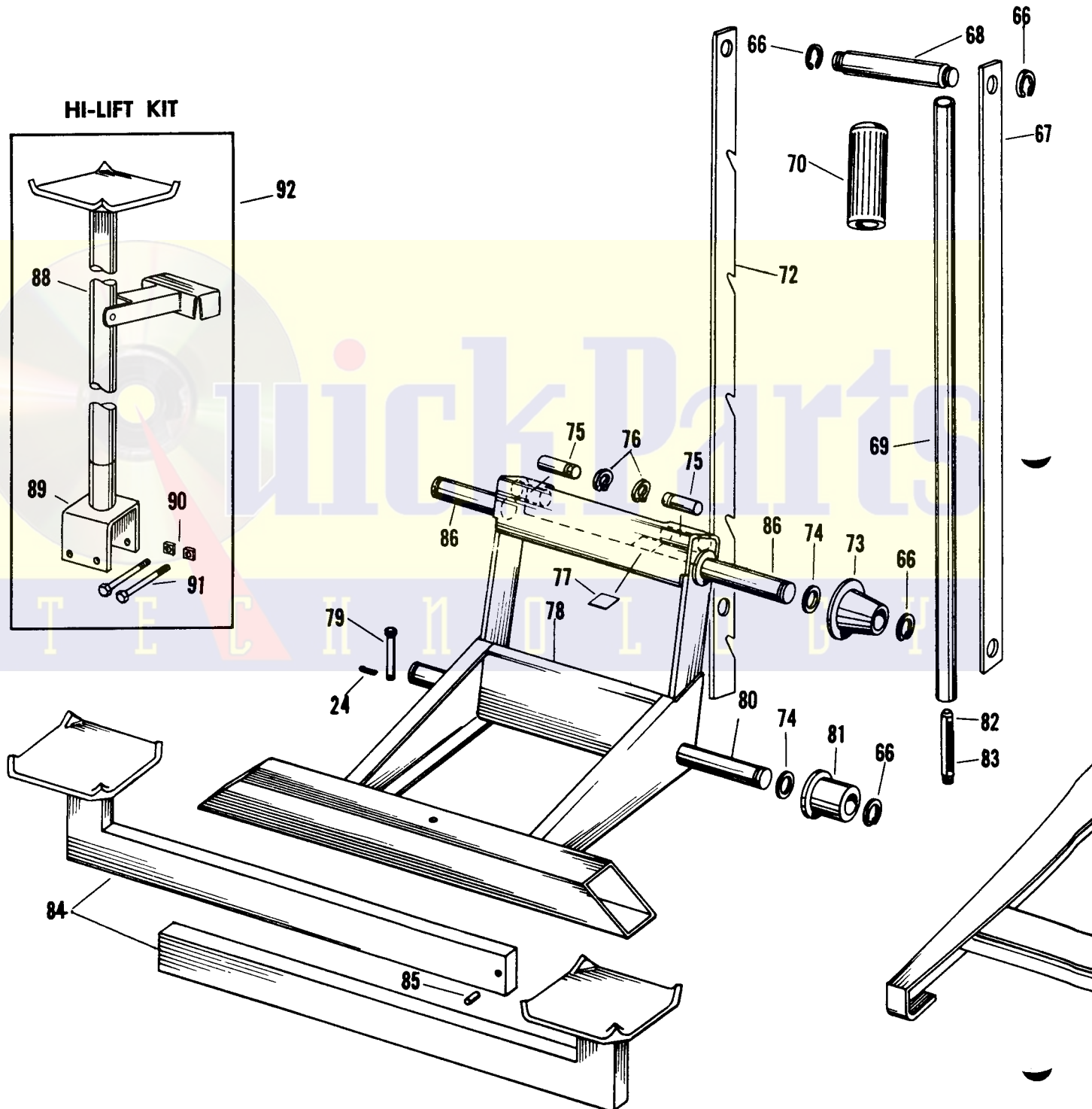
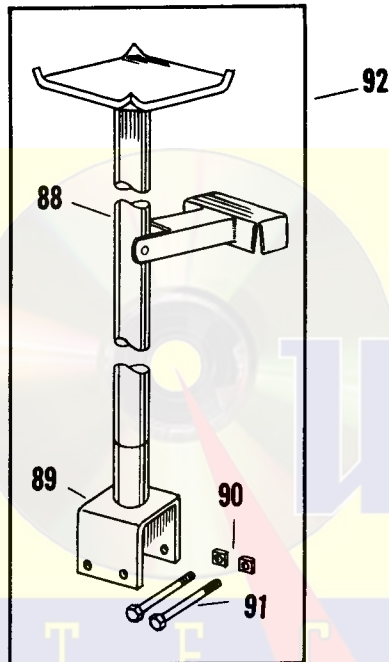

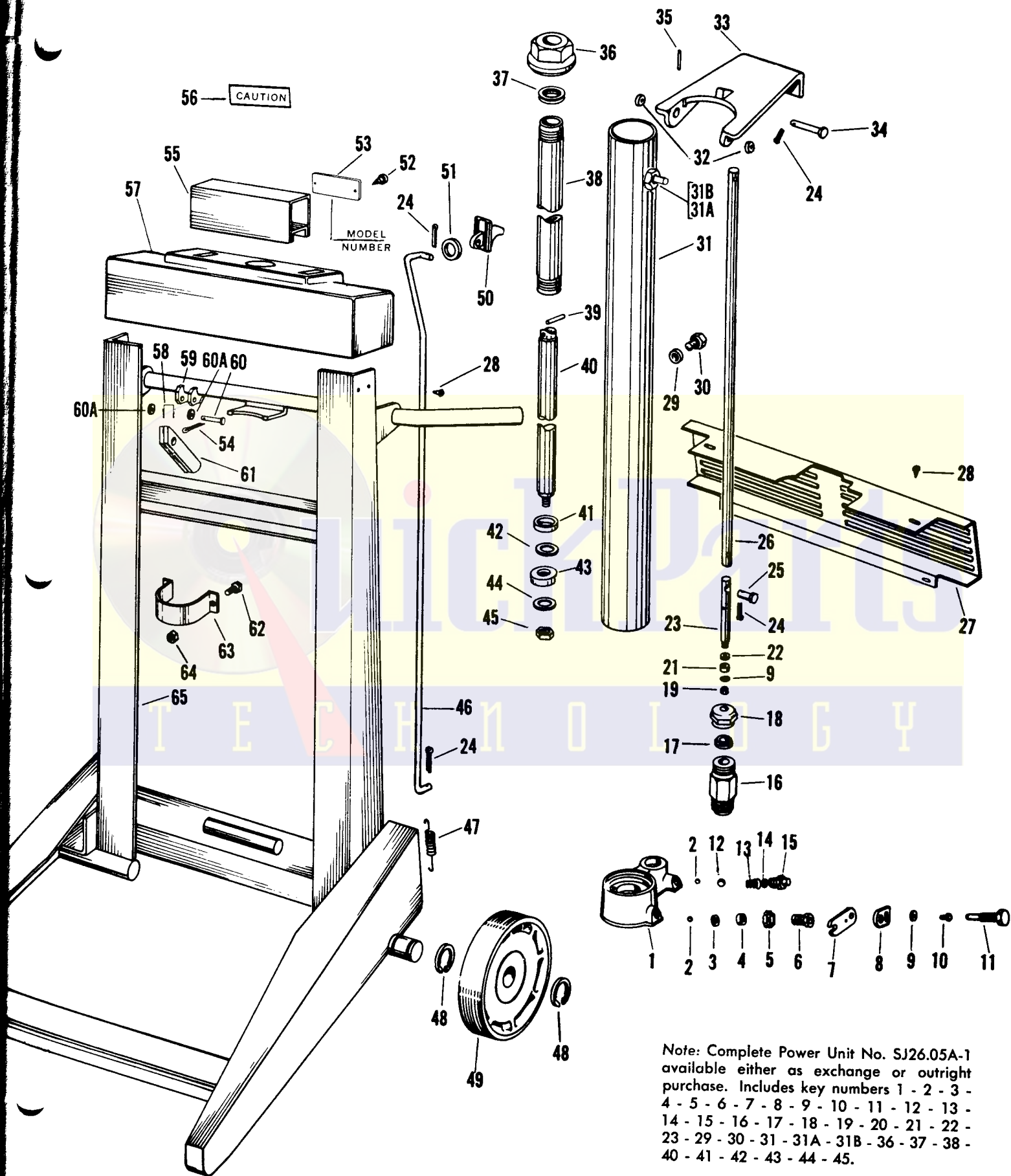

REPAIR PARTS LIST FOR MODEL SJ-26-E ONE-END LIFT

Item No.	Part No.	No. Req.	Description	Item No.	Part No.	No. Req.	Description
1	SJ100.375	1	Base	*54	S1.58	1	Cotter Pin
* 2	1.16	2	7/32" Ball	55	SJ10.102	1	Strap Cover
* 3	1.74	1	Release Packing	56	AJ100.504	1	Decal (Caution)
* 4	CB9.335	1	Washer (Leather)	57	SJ100.387	1	Hood
5	AJ100.218	1	Pal Nut	58	E242.183	1	Spring (Safety Catch)
6	SJ100.095	1	Release Packing Nut	59	SJ100.432	1	Yoke (Safety Catch)
7	AJ100.371	1	Release Extension Arm	60	SJ100.064	1	Clevis Pin
8	AJ100.289	1	Release Arm	60A	SJ100.124	2	Washer
9	SJ100.169	2	Washer	61	E243.900	1	Safety Catch
10	AJ100.293	1	Sems Screw	62	AJ100.207	2	Cap Screw
11	SJ100.302	1	Release Spindle	63	SJ100.385	1	Power Unit Strap
*12	S1.16	1	5/16" Ball	64	SJ100.079	2	Lock Nut
*13	BA85.183	1	Valve Spring	65	SJ10.111	1	Chassis Weldment
*14	B159.167	1	Gasket	66	SJ100.069	6	Retaining Rings
15	AJ100.128	1	Valve Plug	67	SJ100.395	1	Lift Strap (Plain)
16	AJ100.367	1	Pump Cylinder	68	SJ100.440	1	Cross Pin
*17	5.75	1	Pump Packing	69	AJ100.372	1	Pump Handle
18	CB9.54-1	1	Gland Nut	70	AJ100.373	3	Handle Grip
*19	CB9.55	1	Retaining Nut	72	SJ100.434	1	Lift Strap (Notched)
*21	E221.041	1	Pump Cup	73	E207.107	2	Roller (Upper)
*22	B119.317	1	Backup Washer	74	SJ100.087	8	Thrust Washer
23	AJ100.370	1	Pump Plunger	75	SJ100.425	2	Stud (Lift Strap)
*24	1.58	5	Cotter Pin	76	SJ100.217	2	Retaining Ring
25	J19.57	1	Beam Pin	77	SJ100.442	1	Release Tab
26	E237.900	1	Link	78	E208.103	1	Elevator
27	SJ100.383	1	Rear Cover	†78A	E209.900	1	Elevator Assembly
28	SJ100.374	8	Self Tapping Screw				Includes Items 75, 77, 78, 80, 86
*29	C9.37	1	Gasket	79	SJ100.049	1	Stop Pin
30	C9.22-2	1	Filler Plug	80	E206.104	2	Roller Shaft (Lower)
31	E233.025	1	Reservoir	81	SJ100.017	2	Roller (Lower)
31A	E232.028	2	Bolt (Fulcrum Stud)	82	SJ100.201	1	Handle Peg
31B	E231.055	2	Nut (Use with 31A)	83	SJ100.220	1	Handle Peg Spring
‡31C	E234.900	1	Reservoir Assembly	84	SJ10.105	2	Saddle (Includes Item No. 85)
			Includes 31, 31A, 31B	85	SJ100.076	2	Roll Pin
32	SJ100.380	2	Bushing	86	E205.104	2	Roller Shaft (Upper)
33	E235.133	1	Yoke	†88	SJ10.110	1	Saddle
34	E236.061	1	Link Lever Pin	†89	SJ100.419	1	Tube Support
35	SJ100.381	2	Roll Pin	†90	SJ100.420	2	Nut
36	AJ100.319	1	Top Cap	†91	SJ100.414	2	Bolt
*37	AJ100.214	1	Quad Ring	92	SJ-1030	1	Hi-Lift Kit
38	SJ100.377	1	Cylinder	†93	SJ100.405-1	1	Decal (SJ-26)
39	SJ100.390	1	Roll Pin				
40	E149.040	1	Plunger				
41	D270.044	1	Plunger Ring				
*42	D269.108	1	Backup Washer				
*43	E30.041	1	Plunger Cup				
44	AJ100.507	1	Cup Washer				
45	MJ.35	1	Cup Nut				
46	SJ100.441	1	Release Link				
47	SJ100.183	1	Spring				
48	SJ100.070	4	Retaining Ring				
49	SJ100.384	2	Wheel				
50	SJ100.392	1	Release Lever				
51	SJ100.393	1	Release Lever Washer				
52	W78.03	2	Drive Screw				
53	SJ100.386	1	Name Plate				

NOTE: Orders for parts cannot be filled unless both model and serial number with prefix imprinted on nameplate are given.

PARTS, SERVICE INFORMATION AND THE ADMINISTRATION OF FRANCHISED SERVICE DEPOTS FOR BLACKHAWK PRODUCTS IS PROVIDED BY —

BLACKHAWK SERVICE

MILWAUKEE, WISCONSIN 53246

DIVISION OF APPLIED POWER INDUSTRIES, INC.

Please direct all Service Correspondence to BLACKHAWK SERVICE