

**BLACKHAWK®**

*Master Copy*  
**instructions & repair parts**

**MODELS SJ-1-B AND SJ-2-B  
SERVICE JACK**

**RATED CAPACITY**  
**1 1/4 TON & 1 1/2 TON**  
**Supersedes Sheet S-272**

**CAUTION**

THIS JACK IS DESIGNED FOR LIFTING PURPOSES ONLY. AFTER JACKING, ALWAYS USE GARAGE HORSES TO SUPPORT VEHICLE BEFORE MAKING UNDER VEHICLE REPAIRS. DO NOT OVERLOAD THIS JACK BEYOND ITS RATED CAPACITY.

**FOR YOUR SAFETY**

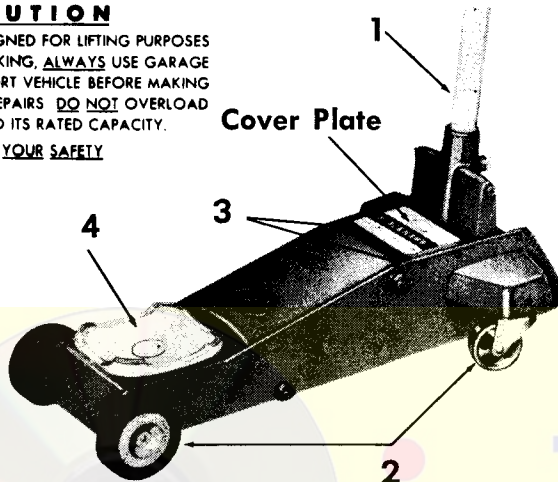

**IMPORTANT:**

Become familiar with the various parts of your new Service Jack, and oil the following points **BEFORE FIRST USE!** Figures on jack illustration match figures below.

1. **Handle** — lubricate moving parts with light oil and grease handle where it enters yoke casting.
2. **Wheels** — lubricate all wheel axles and swivel wheel bearings with light oil.
3. **Lifting Arm** — lubricate at 2 grease fittings.
4. **Saddle and Linkage** — lubricate with light oil all moving and pivoting parts of saddle and linkages on underside of lifting arm.

**HOW TO OPERATE YOUR NEW SERVICE JACK**

1. **To Raise Load — Important** — Before using Service Jack, open release valve by turning handle counterclockwise. Hold Open. Pump handle rapidly about 4 full strokes. This expels air that may have entered the oil channels. Then close release valve by rotating handle clockwise and pump handle until lifting arm, without load, is raised to full height. Open release valve and lifting arm will lower. Your Service Jack is now ready for operation.
2. **To Lower Load** — Turn handle slowly counterclockwise (left). Speed of lowering is controlled by how much you turn the handle. Become familiar with the speed with which the lifting arm lowers. To close release valve, rotate handle clockwise until tight.
3. **To Add Oil** — Open release valve until lifting arm is flat. Remove screws holding cover plate. Remove 7/16" hex filler plug in Power Unit. If oil is low, add Blackhawk LX-21 Oil, until it reaches about 1/4" below top. If oil is dirty, thick or gummy, remove it and clean reservoir. Again, refill up to 1/4" below top. Do not overfill because too much oil will cause faulty lifting due to lack of air space.
4. **To Lubricate** — see illustration for location of oil and grease points. Frequently and thoroughly oil and grease all moving parts as designated for continued ease of operation and long Service Jack life. For major service or repair, send your Service Jack to the nearest Blackhawk Franchised Service Depot.

**DO NOT ROTATE HANDLE MORE THAN TWO TURNS TO RELEASE!**

**FRANCHISED SERVICE DEPOTS**



For quality workmanship with genuine Blackhawk parts select a Franchised Blackhawk Service Depot for your repair work. Only repairs performed by a Franchised Service Depot displaying this official sign are backed with full factory guarantee. The Classified Section in your Phone Book lists your nearest Franchised Service Depot.

**GUARANTEE**

Blackhawk guarantees this Product against defects in workmanship and materials for 12 months from date of delivery to user. Except as noted all other products are guaranteed for 90 days from date of delivery. Chain is not guaranteed. When question of warranty arises, the user should send his unit to the nearest Blackhawk Franchised Service Depot for inspection, transportation to be prepaid and evidence of purchased date furnished.

If the difficulty comes under the terms of our guarantee, the Franchised Service Depot will repair or replace parts affected and return prepaid. Our guarantee does not cover ordinary wear and tear, abuse, misuse, overloading, altered products or use of improper fluid.

**PARTS, SERVICE INFORMATION AND THE ADMINISTRATION OF FRANCHISED SERVICE DEPOTS FOR BLACKHAWK PRODUCTS IS PROVIDED BY —**

**BLACKHAWK SERVICE**

MILWAUKEE, WISCONSIN 53246

DIVISION OF APPLIED POWER INDUSTRIES, INC.

**Please direct all Service Correspondence to BLACKHAWK SERVICE**

**WHEN ORDERING PARTS INCLUDE BOTH MODEL AND SERIAL NUMBER AS WELL AS PART NAME AND NUMBER**

**USE ONLY BLACKHAWK  
LX-21 JACK OIL AND  
GENUINE FACTORY PARTS.**

**USE OF OTHER  
HYDRAULIC FLUIDS OR  
NON-GENUINE PARTS  
VOIDS WARRANTY. NEVER  
USE BRAKE FLUID.**

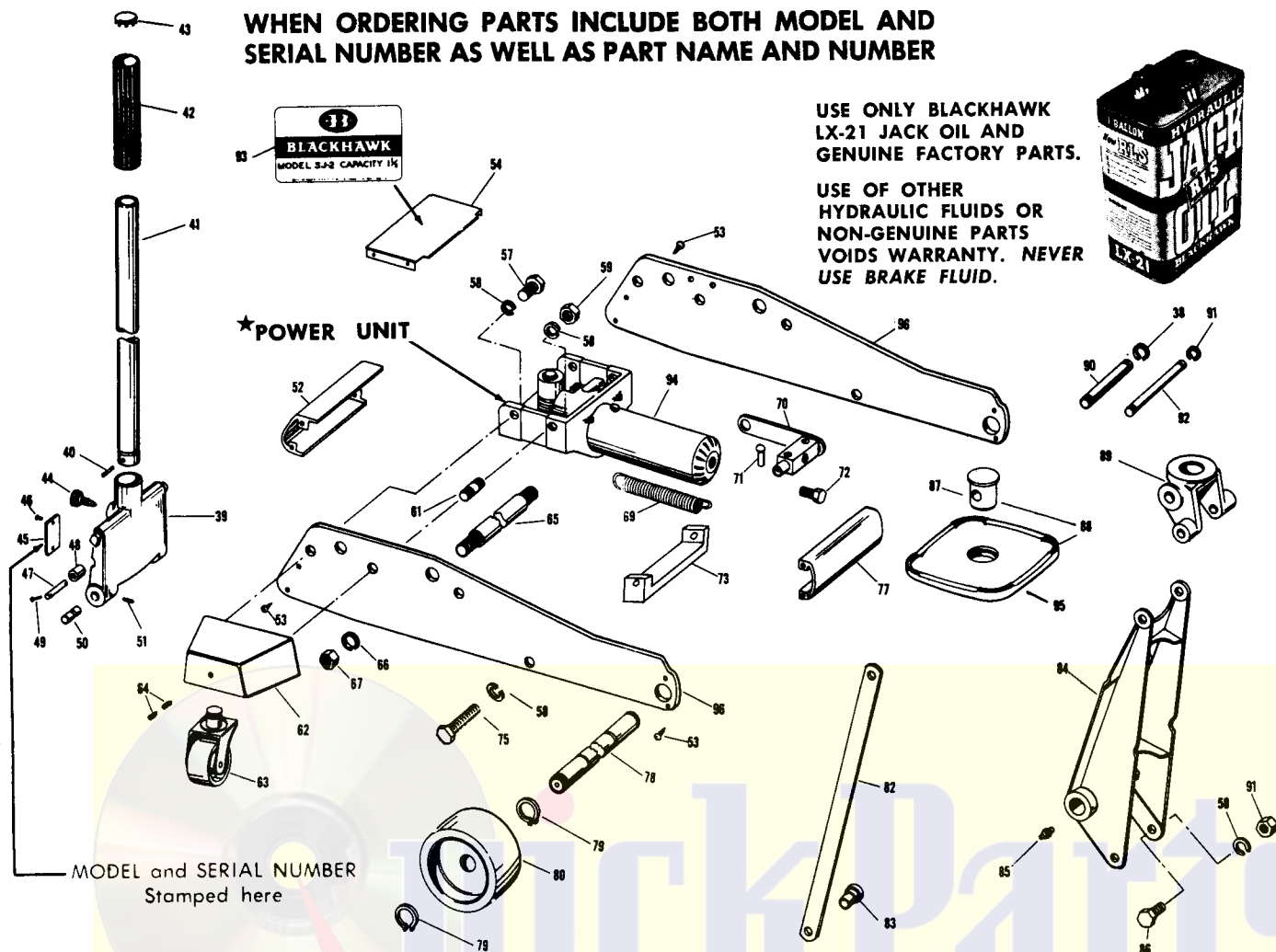

Item	SJ-1-B Part No.	SJ-2-B Part No.	No. Req.	Description	Item	SJ-1-B Part No.	SJ-2-B Part No.	No. Req.	Description
38	W407.524	W407.524	2	Retaining Ring	67	S1.120	S1.120	2	Nut
39	A691.133	A677.133	1	Yoke	69	A669.184	A669.184	2	Return Spring
40	A676.061	A676.061	1	Handle Pin	70	A661.900	A685.900	1	Linkage Assembly
41	SJ1.135	SJ2.135	1	Handle Assy. (40-41-42-43)	71	A668.063	A668.063	2	Rivet
42	None	A794.550	1	Grip	72	A797.242	A797.242	1	Bolt
43	None	A795.006	1	End Plug	73	A694.396	E150.111	1	Bracket
44	A423.138	A423.138	1	Handle Screw	75	A866.247	A866.247	2	Cap Screw
45	A737.026	A742.026	1	Yoke Name Plate	77	A781.098	A783.098	1	Front Cover
46	W78.03	W78.03	2	Drive Screw	78	A980.104	A981.104	1	Front Axle
47	A680.153	A680.153	1	Roller Pin	79	A434.523	A434.523	4	Retaining Ring
48	A679.232	A679.232	1	Roller	80	A976.106	A977.106	2	Front Wheel
49	S1.58	S1.58	2	Cotter Pin	82	A701.116	A657.116	2	Parallel Link
50	A678.121	A678.121	2	Handle Fulcrum Pin	83	A695.064	A686.064	2	Rivet
51	R28.61	R28.61	2	Pin	84	A688.103	A682.103	1	Lift Arm
52	A782.098	A784.098	1	Rear Cover	85	S4.188-2	S4.188-2	2	Grease Fitting
53	A751.087	A751.087	12	Screw	86	A757.242	A681.242	2	Pivot Bolt
54	A792.098	A793.098	1	Top Cover	87	A945.153	A946.153	1	Saddle Retainer
57	A674.247	A674.247	2	Cap Screw	88	A945.999	A946.999	1	Saddle Assy. (87-95)
58	S8.222	S8.222	7	Lock Washer	89	A690.111	A662.111	1	Bracket
59	AA85.120	AA85.120	4	Nut	90	A697.112	A665.112	1	Bracket Pivot Pin
61	A683.305	A683.305	2	Stud	91	A664.523	A664.523	2	Retaining Ring
62	A671.189	A671.189	2	Caster Bracket	92	A698.114	A663.114	1	Link Pivot Pin
63	A673.154	A673.154	2	Caster		AJ100.503	AJ100.503	1	Caution Decal (Not shown)
64	A672.173	A672.173	4	Screw	93	A741.026	A776.026	1	Identification Decal
65	A693.121	A670.121	1	Fulcrum Pin	*94			1	Power Unit, Complete
66	S1.119	S1.119	2	Lock Washer	95	A942.045	A943.045	1	Saddle
					96	A699.101	A656.101	2	Side Plate

\*For parts information on power unit, see repair parts sheet matching model number on power unit name plate. If no name plate, see parts sheet for SJ1.05A-2 for SJ-1 or SJ2.05A-2 for SJ-2. Use of factory exchange power units is recommended.