

BLACKHAWK®

Master Copy
repair parts

**MODEL SA-4 & SA-6
PORTO-POWER WEDGIE RAM**

(ALSO IDENTIFIED AS Z-577)

RATED CAPACITY — 1 TON

Issued November, 1964 — Supercedes Sheet S1041

TO DISSASSEMBLE

Remove pull spring
pin (Item 4)

Drive out pivot pin
(Item 1)

CURRENT DESIGN

BANTAM ZR-630 SPEE-D-COUPLER

ZR-400 SPEE-D-COUPLER

INTERMEDIATE DESIGN

EARLY DESIGN

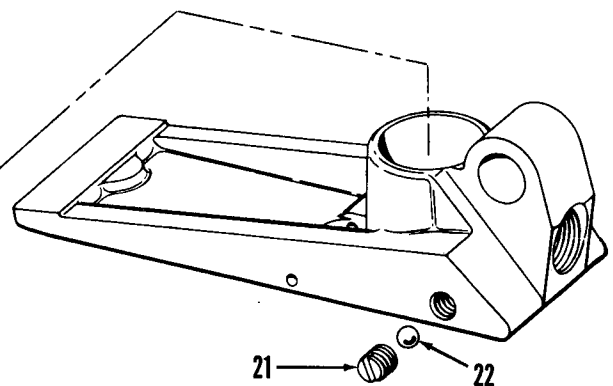
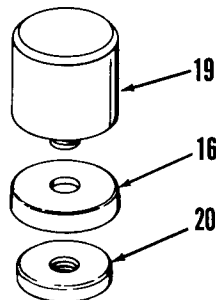
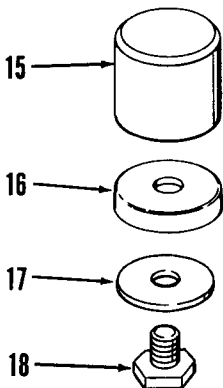

REPAIR PARTS LIST FOR MODELS SA4, SA6, Z577

Item No.	Part No.	No. Req.	Description	Item No.	Part No.	No. Req.	Description
1	A128.121	1	Pivot Pin	18	B493.247	1	Cap Screw
2	Z1199	1	Retaining Ring	†19	Z583	1	Plunger
3	Z579-2	1	Wedge Spoon	20	B25.043	1	Plunger Cup Spreader
4	Z581	2	Pull Spring Pin	21	Z584	1	Air Vent Screw
5	E292.040	1	Plunger	22	1.16	1	7/32" Dia. Steel Ball
* 6	C814.041	1	Plunger Cup	‡23	Z529	1	Decal (Caution)
7	C579.049	1	Retaining Ring	‡Item not shown.			
8	Z582	2	Pull Spring				
9	A127.005	1	Wedge Base				
10	X23.343	1	Adaptor				
11	ZR-630	1	Spee-D-Coupler				
12	Z640-1	1	Valve Closure	†Item 15 (No longer available). Replaced by Items 5, 6 and 7. Item 19 (No longer available). Replaced by Items 5, 6 and 7.			
13	ZR-400	1	Spee-D-Coupler				
14	Z410-1	1	Valve Closure	*For economy repair use Jack/Saver Kit R242K-1. Items included in Kit marked with an asterisk (*).			
†15	B518.040	1	Plunger				
16	B27.041	1	Plunger Cup				
17	B491.043	1	Plunger Cup Spreader				

NOTE: Orders for parts cannot be filled unless both model and serial number with prefix imprinted on nameplate are given.

FRANCHISED SERVICE DEPOTS



official sign are backed with full factory guarantee. The Classified Section in your Phone Book lists your nearest Franchised Service Depot.

For quality workmanship with genuine Blackhawk parts select a Franchised Blackhawk Service Depot for your repair work. Only repairs performed by a Franchised Service Depot displaying this

GUARANTEE

Blackhawk guarantees its Products against defects in workmanship and materials for 90 days from date of delivery to the user. Only exception is chain, which follows the trade custom of its manufacturers and cannot be guaranteed.

When question of warranty arises, the user should send his unit to the nearest Blackhawk Franchised Service Depot for inspection, transportation to be prepaid and evidence of purchased date furnished.

If the difficulty comes under the terms of our guarantee, the Franchised Service Depot will *repair or replace parts affected* and return prepaid. Our guarantee does not cover ordinary wear and tear, abuse, misuse, overloading, altered products or use of improper fluid.

PARTS, SERVICE INFORMATION AND THE ADMINISTRATION OF FRANCHISED SERVICE DEPOTS FOR BLACKHAWK PRODUCTS IS PROVIDED BY —

BLACKHAWK SERVICE

MILWAUKEE, WISCONSIN 53246

DIVISION OF APPLIED POWER INDUSTRIES, INC.

Please direct all Service Correspondence to BLACKHAWK SERVICE