

Master Copy

BLACKHAWK

REPAIR PARTS SHEET
PORTO-POWER RAM
MODEL R-75-2

RATED CAPACITY
7-TON
Sheet No. S-175
Issued April, 1960

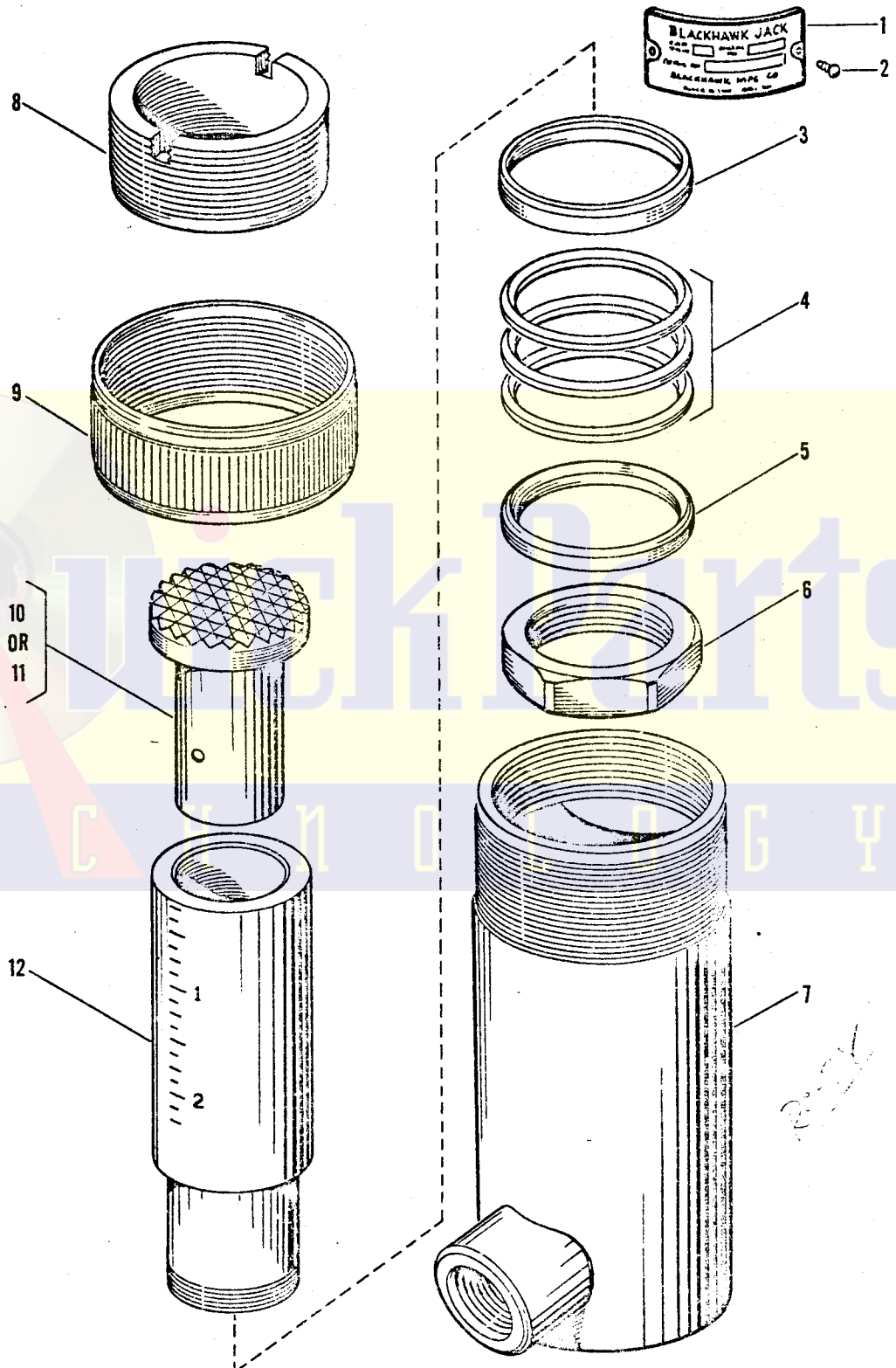

Parts List on Reverse Side



REPAIR PARTS SHEET FOR R-75-2 PORTO-POWER RAM

Item No.	Part No.	Part Name	Req. No.
1	B155.026	.Name Plate	1
2	W78.03	.Drive Screw	2
3	R159.71	.Disc	1
4	B640.041	.Plunger Cup	3
5	R159.43-1	.Spreader	1
6	R159.35-1	.Plunger Cup Nut	1
7	B626.900	.Base	1
8	B627.044	.Plunger Stop Ring	1
9	R28.271	.Thread Protector	1
10	R75.902	.Saddle Assem.	1
* 11	R75.901	.Male Adapt. Assem.	1
12	B624.040	.Plunger	1

* Not Shown

NOTE: Orders for parts cannot be filled unless both model and serial number stamped on side of base are given.

GUARANTEE

Blackhawk guarantees its Hand Jacks, Service Jacks and Porto-Power against defects in workmanship and material for 90 days from date of delivery to the user. Only exception is Porto-Power chain, which follows the trade custom of its manufacturers and cannot be guaranteed.

When question of warranty arises, the user should send his unit to the nearest Blackhawk Franchised Service Depot for inspection, or to the Blackhawk Service Division, 5054 W. State St., Milwaukee 8, Wis.; transportation to be prepaid and evidence of delivery date furnished.

If the difficulty comes under the terms of our guarantee, we will repair or replace parts affected and return prepaid. Our guarantee does not cover ordinary wear and tear, abuse, misuse, overloading, altered products or use of improper fluid.

A Network of FRANCHISED SERVICE DEPOTS serves Blackhawk Users worldwide

For quality workmanship with genuine Blackhawk parts select a franchised Blackhawk Service depot for your repair work. Only repairs performed by a franchised service depot displaying an official franchise service depot sign shown on the reverse side of this page, are backed with full factory guarantee. The Classified Section in your Phone Book lists your nearest Franchised Service Depot.