

**BLACKHAWK®**

*Master Copy*  
**repair parts**

**MODEL ML-50  
MOBILE LIFT**

**RATED CAPACITY — 2¾ TON**

Issued September, 1965 — Supersedes Sheet S-162

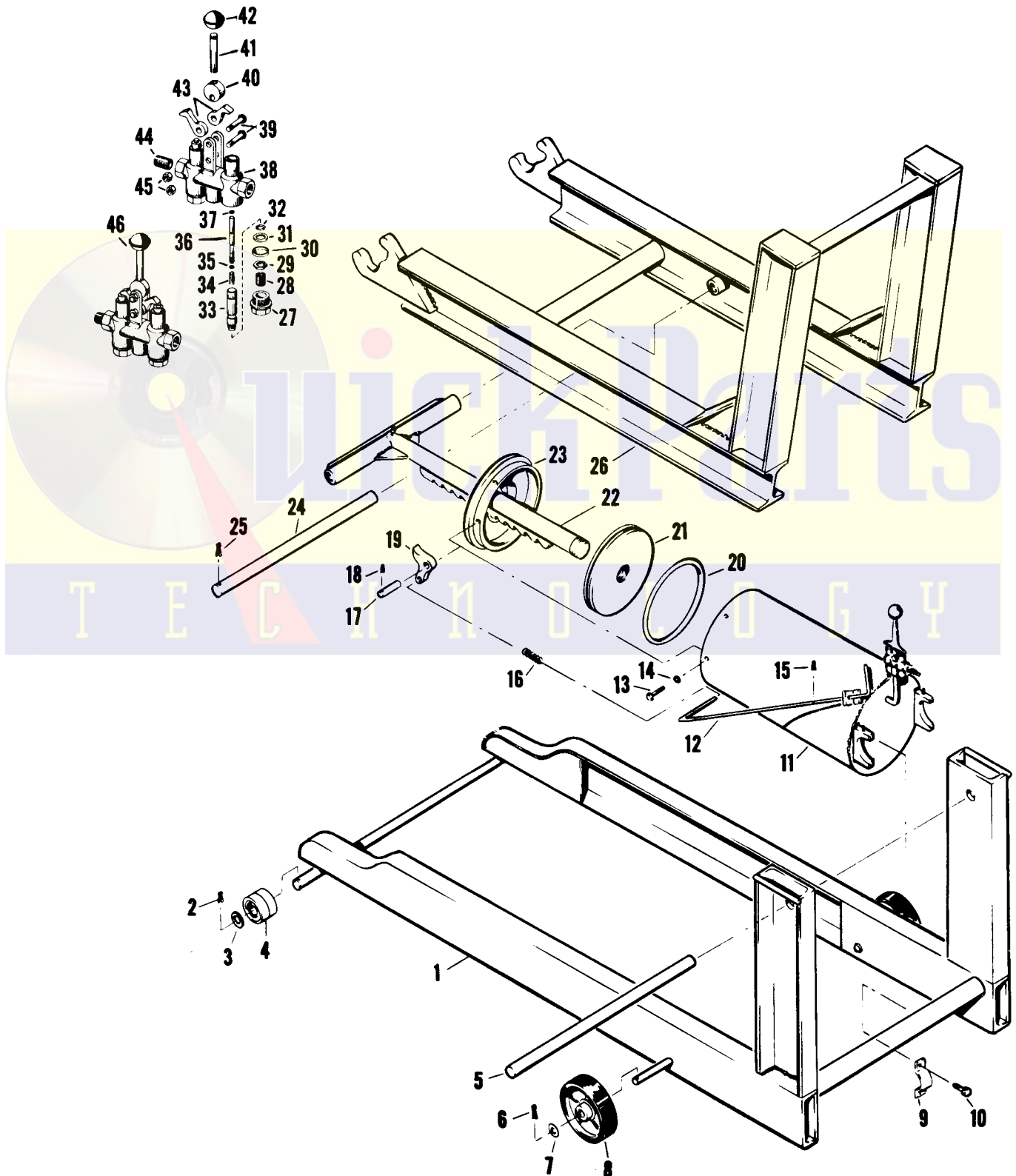

# REPAIR PARTS LIST FOR MODEL ML-50 MOBILE LIFT

Item No.	Part No.	No. Req.	Description	Item No.	Part No.	No. Req.	Description
1	E845.001	1	Frame	30	E873.071	2	Disc
* 2	E846.061	2	Cotter Pin	31	E874.071	2	Disc
3	E847.108	2	Washer	*32	B710.503	2	"O" Ring
4	E848.106	2	Wheel (Front)	33	E875.010	2	Spindle
5	E849.104	1	Shaft	34	E876.183	2	Spring
6	E850.061	2	Cotter Pin	*35	B744.503	2	"O" Ring
7	E189.108	2	Washer	36	E877.010	2	Spindle
8	E851.106	2	Wheel (Rear)	37	B744.503	2	"O" Ring
9	E852.017	2	Strap	38	E878.580	1	Valve Body
10	E853.028	4	Bolt	39	E879.028	2	Bolt
11	E854.900	1	Tank Assembly	40	E880.350	1	Cam
12	E855.149	1	Safety Release Rod	41	E881.157	1	Lever
13	E856.028	6	Bolt	42	E882.308	1	Knob
14	E857.108	6	Washer	43	E883.103	2	Rocker Arm
15	E858.061	1	Cotter Pin	44	E884.431	1	Nipple
16	E859.183	1	Spring	45	E885.055	2	Nut
17	E860.061	1	Pin	46	E886.900	1	Valve Assembly
*18	E861.061	2	Cotter Pin	†47	E764.026	1	Nameplate
19	E862.817	1	Safety Latch	†48	W78.03	2	Drive Screw
*20	E863.041	1	"O" Ring	†49	A537.026	2	Decal (ML-50)
21	E864.040	1	Piston	†50	A559.026	1	Decal (Caution)
22	E865.900	1	Piston Assembly	†51	E775.026	1	Decal (Oper. and Maint. Instr.)
23	E866.020	1	End Cap				
24	E867.104	1	Shaft				
*25	E868.061	1	Cotter Pin	†Item Not Shown  *For economy repair use Jack/Saver Kit ML50K. Items included in Kit marked with an asterisk (*).			
26	E869.900	1	Lift Arm Assembly				
27	E870.020	2	Valve Cap				
28	E871.183	2	Spring				
29	E872.055	2	Nut				

**NOTE:** Orders for parts cannot be filled unless both model and serial number with prefix imprinted on nameplate are given.

## FRANCHISED SERVICE DEPOTS



For quality workmanship and genuine Blackhawk parts select a Franchised Blackhawk Service Depot for your repair work. Only repairs performed by a Franchised Service Depot displaying this official sign are backed with full factory guarantee. The Classified Section in your Phone Book lists your nearest Franchised Service Depot.

## GUARANTEE

Blackhawk guarantees its Products against defects in workmanship and materials for 90 days from date of delivery to the user. Only exception is chain, which follows the trade custom of its manufacturers and cannot be guaranteed. When question of warranty arises, the user should send his unit to the nearest Blackhawk Franchised Service Depot for inspection, transportation to be prepaid and evidence of purchased date furnished. If the difficulty comes under the terms of our guarantee, the Franchised Service Depot will repair or replace parts affected and return prepaid. Our guarantee does not cover ordinary wear and tear, abuse, misuse, overloading, altered products or use of improper fluid.

PARTS, SERVICE INFORMATION AND THE ADMINISTRATION OF FRANCHISED SERVICE DEPOTS FOR BLACKHAWK PRODUCTS IS PROVIDED BY —

# BLACKHAWK SERVICE

MILWAUKEE, WISCONSIN 53246

DIVISION OF APPLIED POWER INDUSTRIES, INC.

Please direct all Service Correspondence to BLACKHAWK SERVICE