

# POWER TEAM

A division of SPX Corporation

2121 West Bridge Street

Owatonna, MN 55060 USA

Phone: (507) 455-7100

Tech. Services: (800) 477-8326

Fax: (800) 765-8326

Order Entry: (800) 541-1418

Fax: (800) 288-7031

International Sales: (507) 455-7150

Fax: (507) 455-7122

Internet Address:

<http://www.powerteam.com>

## Parts List for:

2R51S

2R53S

2R55S

46020

C51C

C51C-LCSP

C51C-PFAFF

C53C

C53C-EZE

C53C-PFAFF

C55C

Form No. 100597

C55C-CMI

C55C-PFAFF

C57C

C57C-ABC

C59C

C59C-ACME

C59C-PAC

## MODEL B SINGLE-ACTING, SPRING RETURN HYDRAULIC CYLINDER Max. Capacity: 5 Ton at 10,061 PSI

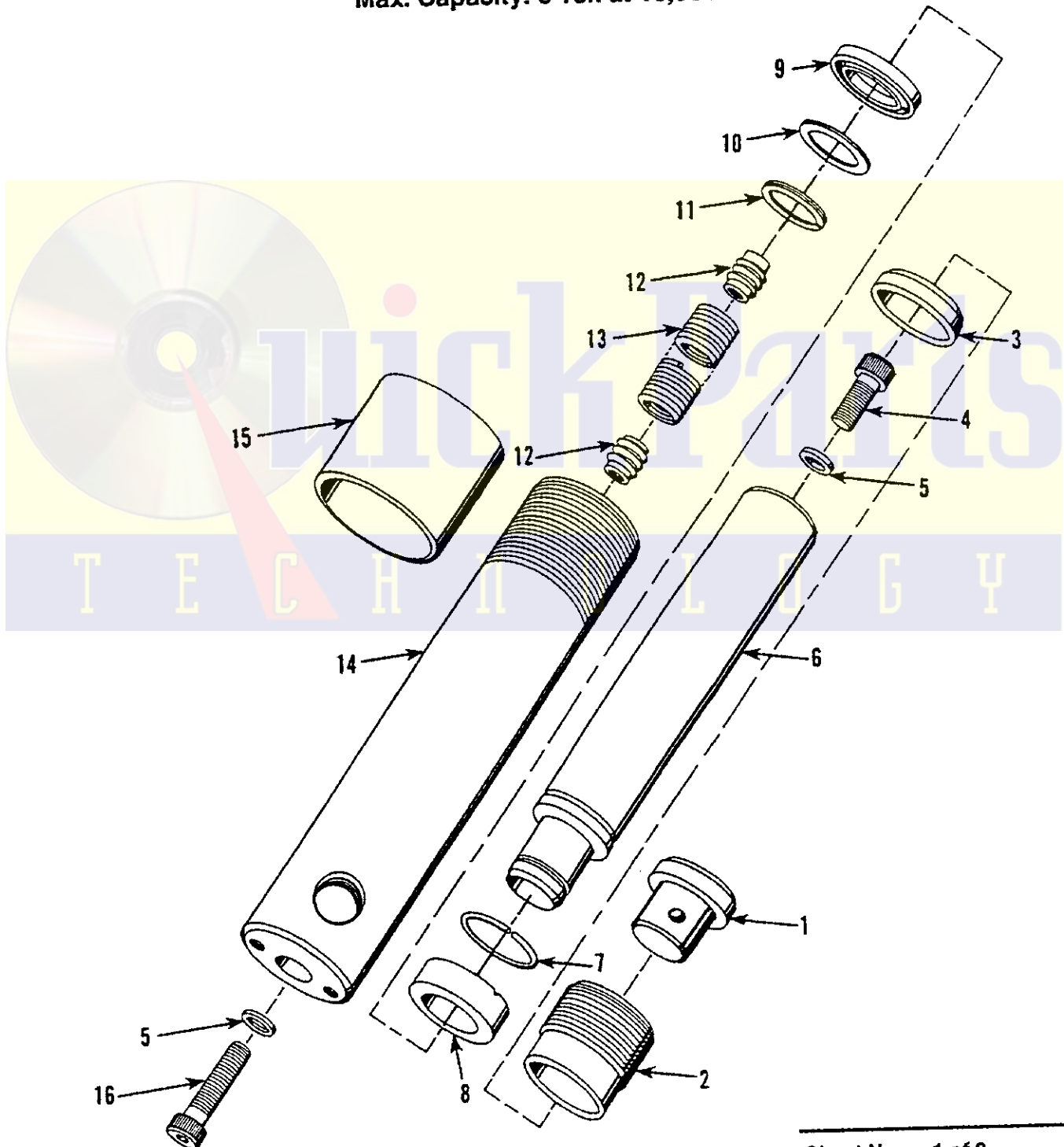

Sheet No. 1 of 2

Rev. 5

Date: 2 June 1997

Note: Shaded areas reflect last revision(s) made to this form.

# Parts List, Form No. 100597, Back sheet 1 of 2

Item No.	Part No.	No. Req'd	Description
1	201375	1	Thread Adapter (For all except C51C-LCSP, C53C-EZE, C59C-ACME, C57C-ABC & C59C-PAC)
2	305065	1	Retainer Nut (Torque to 40/80 in. lbs.)
3	*†201424	1	Rod Wiper
4	15122	1	Soc. Hd. Cap Screw (#10-32 x 5/8 Lg.; Torque to 50/60 in. lbs.)
5	*†14319	2	Copper Washer (5/16 x 3/16 x 1/32)
6	305054	1	Piston Rod (For C51C, C51C-LCSP, 2R51S & C51C-PFAFF)
	305055	1	Piston Rod (For C53C, C53C-PFAFF, C53C-EZE & 2R53S)
	305056	1	Piston Rod (For C55C, C55C-PFAFF, C55C-CMI, 2R55S, & 46020)
	350093	1	Piston Rod (For C57C & C57C-ABC)
	350147	1	Piston Rod (For C59C, C59C-ACME & C59C-PAC)
7	—	1	Round Retaining Ring (Note: This part assembled on piston rod [Item #6].)
8	201377	1	Piston Head (Assemble with groove toward shoulder.)
9	*210391	1	U-cup Piston Seal
	†205703	1	U-cup Piston Seal
10	201373	1	Retainer Washer
11	*13653	1	Retaining Ring
12	201372	2	Spring Retainer (See diagram on pg. 2 of 2)
13	201422	1	Extension Spring (For C53C, C53C-PFAFF, C53C-EZE & 2R53S)
	201423	1	Extension Spring (For C55C, C55C-CMI, 2R55S, C55C-PFAFF & 46020)
	207529	1	Extension Spring (For C51C, C51C-LCSP, 2R51S & C51C-PFAFF)
	250230	1	Extension Spring (For C57C & C57C-ABC)
	250284	1	Extension Spring (For C59C, C59C-ACME & C59C-PAC)
14	42168	1	Cylinder Body (For C53C, C53C-PFAFF, C53C-EZE & 2R53S)
	42170	1	Cylinder Body (For C55C, C55C-PFAFF & 2R55S)
	44773	1	Cylinder Body (For C51C, C51C-LCSP, 2R51S & C51C-PFAFF)
	46012	1	Cylinder Body (For 46020)
	420058	1	Cylinder Body (For C57C & C57C-ABC)
	420083	1	Cylinder Body (For C59C & C59C-PAC)
	420304	1	Cylinder Body (For C55C-CMI)
	421328	1	Cylinder Body (For C59C-ACME)
15	36141	1	Thread Protector (All except 46020, C51C-LCSP, C53C-EZE, C59C-ACME, C55C-CMI, C57C-ABC & C59C-PAC)
16	16071	1	Soc. Hd. Cap Screw (#10-32 x 1" Lg.; Torque to 50/60 in. lbs.)

## PARTS INCLUDED BUT NOT SHOWN

252006	1	Trade Name Decal (For C53C-PFAFF)
252010	1	Trade Name Decal (For C55C-PFAFF)
350202	1	Full Coverage Decal (For C51C)
350203	1	Full Coverage Decal (For C53C & C53C-EZE)
350204	1	Full Coverage Decal (For C55C)
210467	1	Trade Name Decal (For 2R51S)
210468	1	Trade Name Decal (For 2R53S)
210469	1	Trade Name Decal (For 2R55S)
420104	1	Full Coverage Decal (For C57C & C57C-ABC)
420105	1	Full Coverage Decal (For C59C & C59C-PAC)
*203908	1	Warning Decal (For C59C-ACME & C55C-CMI)
252182	1	Tradename Decal (For C51C-PFAFF)

CONTINUED-

NOTE: Shaded areas reflect the last revision(s) made to this form.

Item No.	Part No.	No. Req'd	Description
	203908-CE	1	Warning Decal (For C53C-PFAFF & C55C-PFAFF)
	9796	1	Ram Half Coupler w/ Dust Cap (For C51C, C53C, C53C-PFAFF, C55C-PFAFF, C55C, C53C-EZE, C51C-PFAFF & C57C-ABC)
	210916	1	Ram Half Coupler (For 2R51S, 2R53S, & 2R55S)
	11127	1	Pressure Plug (3/8 NPTF; for 46020, C51C-LCSP, C57C-ABC & C59C-PAC)
	10970	1	Pipe Plug (1/4 NPTF; For C55C-CMI)
	†206555	1	U-cup Backup Washer
	†19526	1	O-ring (1" x 3/4 x 1/8, -210; for coupler)
	†205724	1	Decal (Viton)
	211061	1	Plug (For C59C-ACME)
	212064-CE	1	Warning Decal (For C51C-PFAFF)

Part numbers marked with an asterisk (\*) are contained in Standard Repair Kit No. 300404.  
 Part numbers marked with a dagger (†) are contained in Viton Seal Kit No. 300210.

### SPRING & RETAINER ASSEMBLY

The spring must not extend beyond the threads of the spring retainer on either end. Stretch, clean and lubricate the spring before assembly.

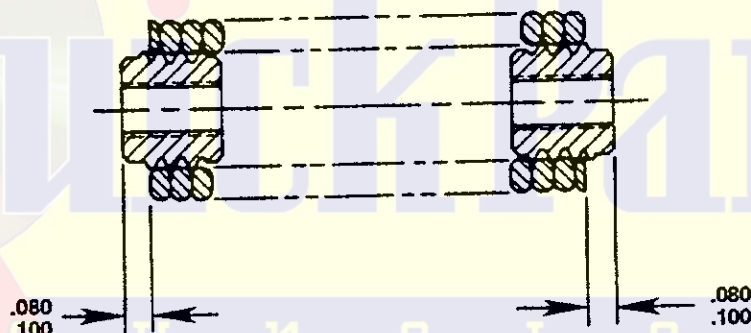

Note: Shaded areas reflect last revision(s) made to this form.

Refer to any operating instructions included with this product for detailed information about operation, testing, disassembly, reassembly, and preventive maintenance.

Items found in this parts list have been carefully tested and selected. **Therefore: Use only genuine Power Team replacement parts!**

Additional questions can be directed to our Technical Services Department.