

POWER TEAM

A division of SPX Corporation

2121 West Bridge Street

Owatonna, MN 55060 USA

Phone: (507) 455-7100

Tech. Services: (800) 477-8326

Fax: (800) 765-8326

Order Entry: (800) 541-1418

Fax: (800) 288-7031

International Sales: (507) 455-7150

Fax: (507) 455-7122

Form No. 100474

Parts List for:

100089	100092
100090	100130
100090 Model B	100131
100091	

CENTER HOLE - SPRING RETURN OR DOUBLE-ACTING HYDRAULIC CYLINDER

Max. Capacity: 5,000 PSI

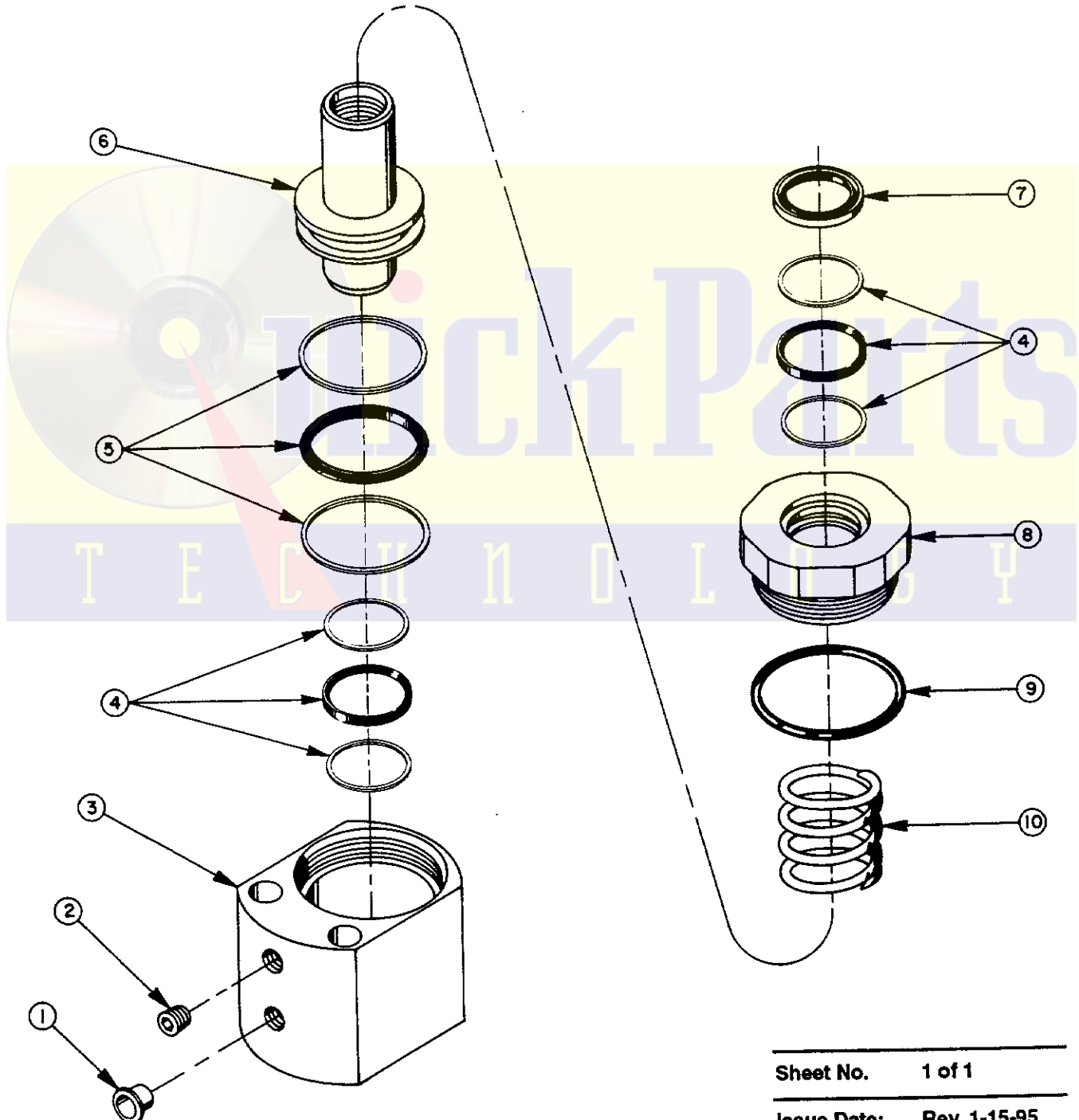

Litho in USA

Sheet No. 1 of 1

Issue Date: Rev. 1-15-95

Parts List, Form No. 100474, Back sheet 1 of 1

Item No.	No. Req'd	Description	Catalog No.					
			100089	100090 †10090"B"	100091	100092	100130	100131
1	1	Plastic Plug	15697	15697	15697	15697	15697	15697
2	1	Vented Pipe Plug	206414	206414	206414	206414	206414	206414
3	1	Cylinder Body	44536	44538	44537	44535	44537	44535
4	2	T-Seal & Backup Ring* (Smooth side of backup ring must be against seal)	15170	15170	15172	15172	15172	15172
5	1	T-Seal & Backup Ring* (Smooth side of backup ring must be against seal)	15166	15166	15168	15168	15168	15168
6	1	Piston	500008	500009	500022	500023	302789	302790
7	1	Rod Wiper *	15088	15088	15089	15089	15089	15089
8	1	Retainer Cap (Torque to 350/370 Ft. Lbs.)	500013	500013	500027	500027	500027	500027
9	1	O-ring*	15125	15125	15182	15182	15182	15182
10	1	Compression Spring	15112	15113 †209177	208730	208730	208730	208730
11	1	Trade Name Decal (Not Shown)	14997	14997	14996	14996	14996	14996
12	1	Patent Decal (Not Shown)	15225	15225	15225	15225	15225	15225

Items marked with an (*) asterisk are contained in a Repair Kit.

Repair Kit No.	300278	300278	300279	300279	300279	300279
----------------	--------	--------	--------	--------	--------	--------

Refer to any operating instructions included with this product for detailed information about operation, testing, disassembly, reassembly, and preventive maintenance.

Items found in this parts list have been carefully tested and selected. Therefore: Use only genuine Power Team replacement parts!

Additional questions can be directed to our Technical Services Department.

Note: Shaded areas reflect last revision(s) made to this form.